

SHORT-TERM IMPROVEMENTS - OPTION 1
CLASS II BIKE LANES
 SCALE 1" = 40'

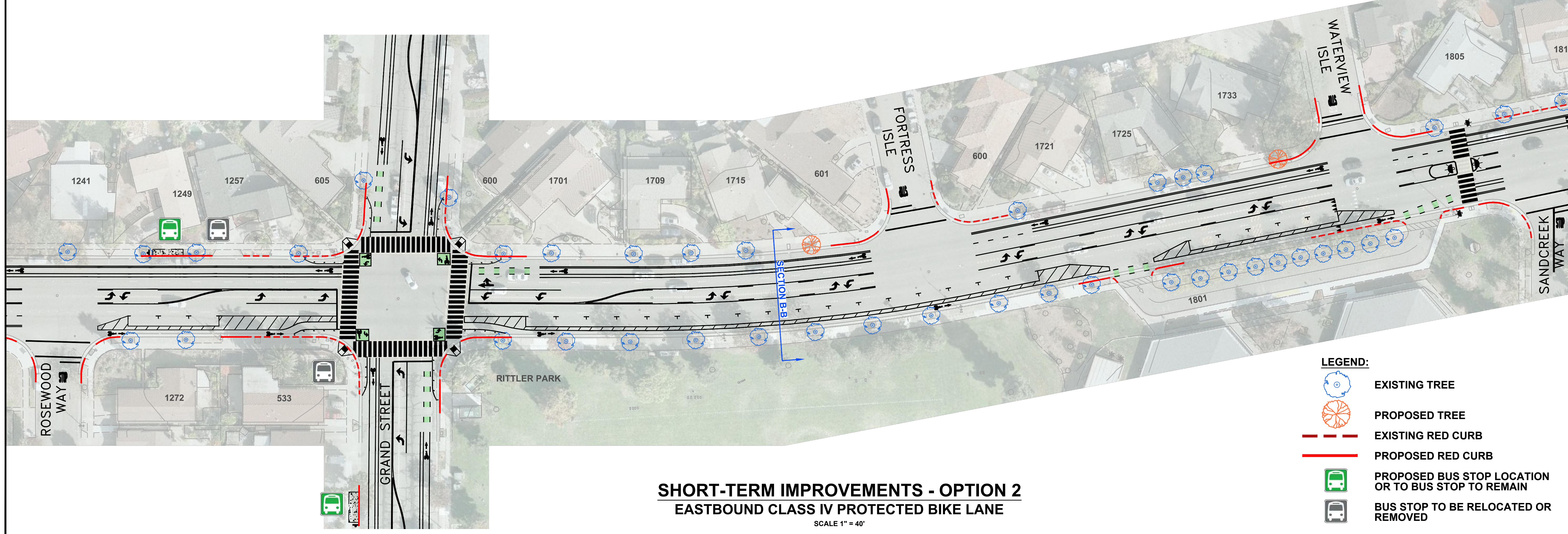

SHORT-TERM IMPROVEMENTS - OPTION 2
EASTBOUND CLASS IV PROTECTED BIKE LANE
 SCALE 1" = 40'

- LEGEND:**
- EXISTING TREE
 - PROPOSED TREE
 - EXISTING RED CURB
 - PROPOSED RED CURB
 - PROPOSED BUS STOP LOCATION OR TO BUS STOP TO REMAIN
 - BUS STOP TO BE RELOCATED OR REMOVED

Parisi
 CSW | DESIGN GROUP

1936 University Avenue, Suite 250
 Berkeley, CA 94704
 T. 510.343.6400
 WWW.PARISI-ASSOCIATES.COM

DRAWN: AG/TE
 DESIGNED: AG/TE
 CHECKED: DP
 APPROVED: DP

CITY OF ALAMEDA
OTIS DRIVE TRAFFIC CALMING AND SAFETY IMPROVEMENTS PROJECT

NO.	REVISIONS	DESCRIPTION

DATE: MAY 2019 SCALE: AS NOTED
 PTC PROJECT NO.: 18044
 DRAWING: **P-1**
 SHEET NO.: **1 OF 3**

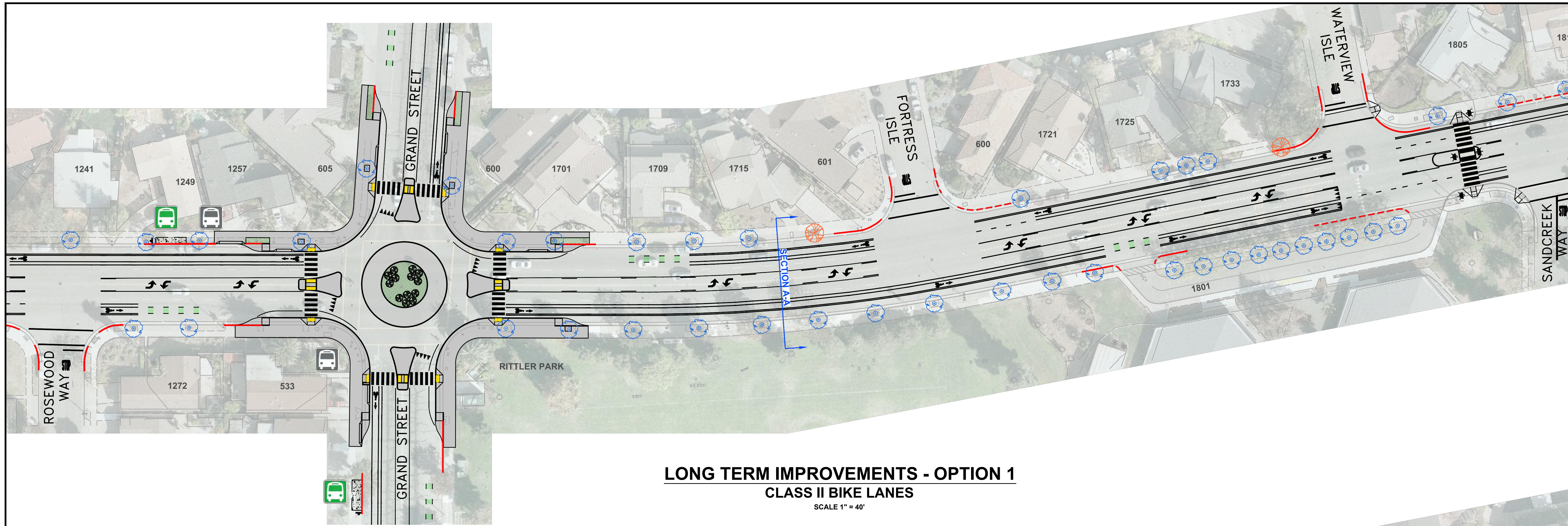





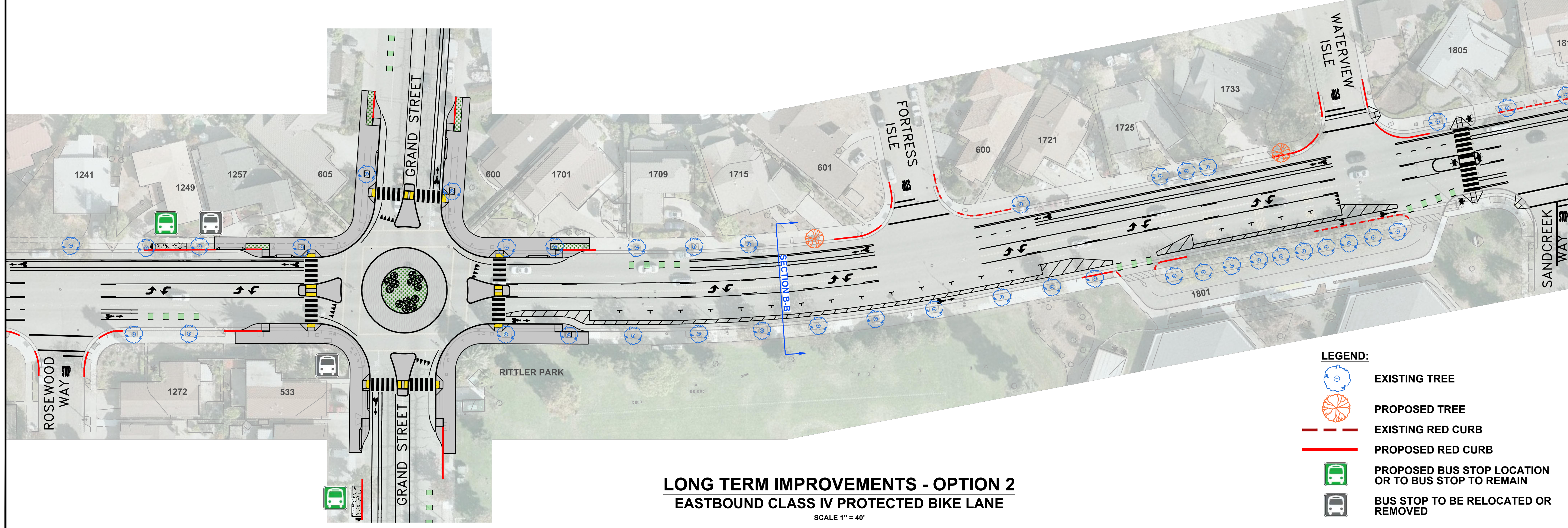

LONG TERM IMPROVEMENTS - OPTION 1
CLASS II BIKE LANES

SCALE 1" = 40'



LONG TERM IMPROVEMENTS - OPTION 2
EASTBOUND CLASS IV PROTECTED BIKE LANE

SCALE 1" = 40'

- LEGEND:**
-  EXISTING TREE
 -  PROPOSED TREE
 -  EXISTING RED CURB
 -  PROPOSED RED CURB
 -  PROPOSED BUS STOP LOCATION OR TO BUS STOP TO REMAIN
 -  BUS STOP TO BE RELOCATED OR REMOVED

Parisi
 CSW DESIGN GROUP

1936 University Avenue, Suite 250
 Berkeley, CA 94704
 T. 510.343.6400
 WWW.PARISI-ASSOCIATES.COM

DRAWN: AG/TE
 DESIGNED: AG/TE
 CHECKED: DP
 APPROVED: DP

CITY OF ALAMEDA
OTIS DRIVE TRAFFIC CALMING AND SAFETY
IMPROVEMENTS PROJECT

REVISIONS	
NO.	DESCRIPTION

DATE: MAY 2019 SCALE: AS NOTED
 PTC PROJECT NO.: 18044
 DRAWING: P-2
 SHEET NO.: 2 OF 3

CLASS II WITH BUFFER OPTION

(LOOKING EASTBOUND)

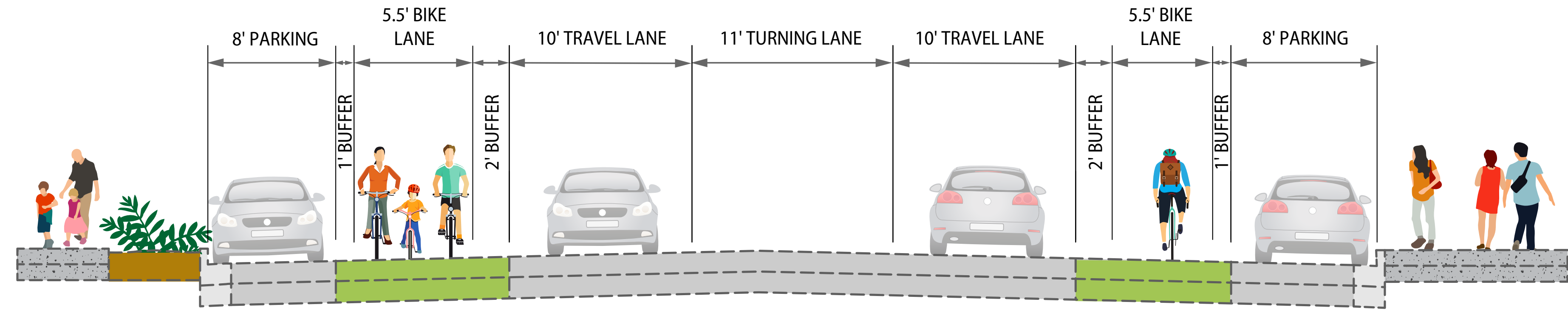

SECTION A-A

EASTBOUND CLASS IV OPTION

(LOOKING EASTBOUND)

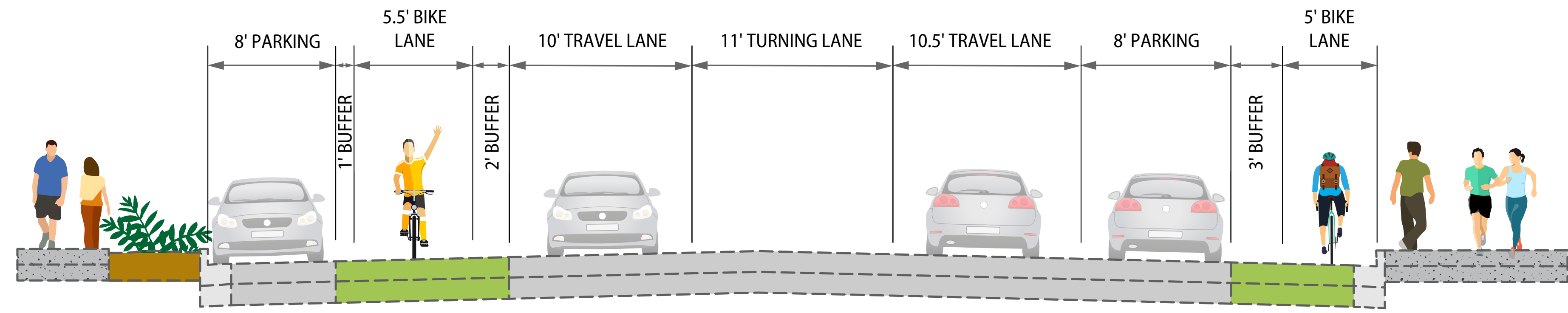

SECTION B-B

**CITY OF ALAMEDA
 OTIS DRIVE TRAFFIC CALMING AND SAFETY
 IMPROVEMENTS PROJECT**

NO.	REVISIONS	DESCRIPTION

DATE: MAY 2019 SCALE: AS NOTED

PTC PROJECT NO.: 18044

DRAWING: P-3

SHEET NO.: 3 OF 3