

From: [Eric Levitt](#)
To: [CityCouncil-List](#)
Cc: [Lara Weisiger](#); [Gerry Beaudin](#); [Yibin Shen](#); [Erin Smith](#); [Andrew Thomas](#); [Eric Levitt](#)
Subject: Information on Slow Streets/ Commercial Streets.
Date: Tuesday, March 2, 2021 3:13:54 PM

Mayor Ezzy Ashcraft & City Council:

Below is information on parklet permitting process.

Eric

Public Works reviews and issues encroachment permits for the parklets. To date, we have not required applicants to submit engineer signed plans for the requested encroachment. This was believed to be a barrier for businesses to apply. The City issued design guidelines for parklets and those are located here: <https://www.alamedaca.gov/files/content/public/alerts-covid-19/commercial-streets-program/parklet-design-guidelines-6-18-20.pdf> Once a permit is issued, the City has augmented any applicant provided parklet barriers with City provided water filled barricades.

The parklet encroachment permit requires the applicant to indemnify the City and name the City as an additional insured on minimum general liability, auto liability and workers compensation coverage.

From: [Eric Levitt](#)
To: [CityCouncil-List](#)
Cc: [Lara Weisiger](#); [Dept-Head](#)
Subject: FW: Public information request - Engineer documentation supporting March 2, 2021 Agenda Item 6-D, Recommendation to Endorse Commercial Streets and Slow Streets.
Date: Tuesday, March 2, 2021 1:55:42 PM
Attachments: [InfoRequest030221.zip](#)

Mayor Ezzy Ashcraft & City Council:

I am forwarding information that was put together in response to a request for further information regarding Slow Streets and Commercial Streets.

Thanks

Eric

From: Erin Smith
Sent: Tuesday, March 2, 2021 1:51 PM
To: Eric Levitt <elevitt@alamedaca.gov>; Andrew Thomas <athomas@alamedaca.gov>; Russ Thompson <rthompson@alamedaca.gov>
Cc: Rochelle Wheeler <rwheeler@alamedaca.gov>; Donya Amiri <damiri@alamedaca.gov>; Gerry Beaudin <gbeaudin@alamedaca.gov>; Lara Weisiger <lweisiger@alamedaca.gov>
Subject: RE: Public information request - Engineer documentation supporting March 2, 2021 Agenda Item 6-D, Recommendation to Endorse Commercial Streets and Slow Streets.

Attached please find a zip file containing the following:

- Design engineer stamped and City Engineer signed striping plans for Park St
- Design Engineer stamped plans for Webster St striping removal/install
 These plans are not signed by the City Engineer; however included is email correspondence from the City Engineer to City Manager stating his support of moving forward with the striping
- Schematic details for temporary traffic control for Slow Streets. The City Engineer did not stamp or sign the temporary traffic control plans for Slow Streets, as they are not consistent with MUTCD design standards.

Please let me know if more is needed.

Erin Smith

City of Alameda
Public Works Director
510-747-7938 (office)
415-812-3746 (cell)



From: Eric Levitt

Sent: Sunday, February 28, 2021 3:51 PM

To: Andrew Thomas <athomas@alamedaca.gov>; Erin Smith <ESmith@alamedaca.gov>

Cc: Rochelle Wheeler <rwheeler@alamedaca.gov>; Donya Amiri <damiri@alamedaca.gov>; Gerry Beaudin <gbeaudin@alamedaca.gov>

Subject: FW: Public information request - Engineer documentation supporting March 2, 2021 Agenda Item 6-D, Recommendation to Endorse Commercial Streets and Slow Streets.

In regards to this Tuesday's (March 2, 2021), City Council Agenda Item 6-D, Recommendation to Endorse Commercial Streets, Slow Streets, and Paid Parking COVID-19 Program Next Steps. (Planning, Building and Transportation 422628,

I'd like copies of all City Engineer, or other engineer's, approvals and comments for each "Commercial Street" and "Slow Street," and modifications and requested upgrades thereto, as referenced in the above agenda item, including but not limited to:

"The key activities visible on the ground include the following:

- 4.5 miles of streets have been temporarily re-configured with temporary barriers and signs to discourage through traffic, while still allowing emergency vehicles and those needing to access a destination on the street, like residents and delivery drivers.
- The core blocks of Park Street and Webster Street have been restriped to support business needs for additional space to address public safety and COVID-19 by creating more space for people to safely walk along the commercial corridors while physically distancing, safely stand in lines to shop at businesses, and provide additional space for outdoor restaurant dining and retail sales.
- Half a block of Alameda Avenue has been closed to provide outdoor dining space for Park Street restaurants." ; and,

"re-configuration by adding additional barriers and enhancing existing barriers,".

PARK STREET

[-2'-][---4'---][---4'---][---4'---][---3'---][---6'---][---4'---][---6'---][---3'---]

35' 0"

Yogofina

Kumon

Taqueria Ramiro & Sons

11' 8"

20' EMERGENCY ACCESS LANE

ROAD CLOSED
R11-2

Parklet

Three Stream

The Local

All Good Living

Alameda Historical Museum

11' 8"

ALAMEDA AVENUE

ROAD CLOSED
R11-2





35' 0"

Three Stream

PRIVATE DRIVEWAY

CITY LOT C

MAP KEY

-  ACI Receptacles: Residents & Business: **Collection Day Location ONLY**
-  Water Filled Barricade
-  Type 2 Barricade
-  Wine Barrels
-  Picnic Tables



**Environmental Services Division, Public Works Department
Special Event Permit Conditions
Downtown Alameda: Alameda Avenue Dining Area
August 27, 2020
Alameda Avenue at Park Street**



Special Event Permit #SE20-0053

The following conditions shall be required for all special event permit applications within the City of Alameda in compliance with the City of Alameda Municipal Code, DISPOSABLE FOOD SERVICE WARE, [Sec. 4-4](#); SOLID WASTE AND RECYCLING [Sec. 21-2.1](#), [Sec. 21-2.7](#), [Sec. 21-3.2-3.7](#); and [Sec. 18-21 to 18-25](#) STORM WATER MANAGEMENT AND DISCHARGE CONTROL. Additionally, Alameda requires compliance with ACWMA Mandatory Recycling Ordinance [2012-01](#); and Reusable Bag Ordinance [2012-02](#), [2016-2](#).

Conditions checked below apply to this permit:

✓ Applicant is responsible for the cleanup of all litter and debris associated with this event and must ensure availability of sufficient garbage, recycling, and compost receptacles. Recycling and Composting is required.

✓ Arrangements **must** be made with the City's franchised hauler, Alameda County Industries (ACI), to have adequate solid waste, commingled recycling services and appropriate organic collection capacity as a condition of this permit.

Call 510-483-1400 to arrange for service.



REVISED SECTION – see reverse for details:

- ✓ Applicant must ensure that polystyrene foam (aka Styrofoam) food service ware is **not** used at the event.
- ✓ Applicant and/or Vendors **may not offer drinking straws** to attendees unless the customer has specifically requested that straw.
- ✓ Applicant must
 - a) strive to **use reusable** food service ware, or if unable to do so must
 - b) ensure the use of disposable **compostable-fiber* food service ware**.
 (*Examples: paper straws, cups, containers, bags, plates; wood or bamboo utensils.)

Large Event:

If this is a large event (more than 2000 attendees expected), Environmental Services *requires* (per California State Law, AB 2176) a solid waste and recycling plan* at least one week prior to the event. ***City staff and/or ACI staff will provide assistance in developing this plan and report upon request. Please call 510-747-7900.**

✓ Applicant must ensure that no pollutants, including food waste/grease, liquid wastes, garbage/debris, animal waste, other materials or washwaters are discharged to the City's storm sewer system (including gutters, curbs and storm drains). Incorporate best management practices (BMPs) to prevent illicit discharges to storm drains.

Large Event/Concessions:

Applicant shall, prior to permit approval, provide documentation acceptable to the Public Works Director identifying the process for removing and disposing of food/drink concessions liquid wastes and washwaters from the event. This documentation shall include: (1) an event map indicating liquid waste and grey water handling locations; (2) proof of contract for liquid waste disposal services; and (3) a description of event washwater management strategies.

If you have any questions about the above, please contact ESD staff directly at (510) 747-7900.



FOOD WARE REVOLUTION



REUSABLE
IS THE
BEST OPTION



COMPOSTABLE FIBER
IS
COMPLIANT



PLASTIC
IS
NOT ALLOWED



SIX QUICK FACTS

1. Alameda's Disposable Food Service Ware Reduction Law went into effect on January 1, 2018. Fines may apply to non-compliant food vendors.
2. Going reusable is best for the environment, and saves restaurants money. Diners are encouraged to bring their own straws and other reusables like to-go coffee mugs and reusable take-out containers.
3. Straws are available only upon request, and when requested single-use straws must be made from a compostable fiber-like paper, bamboo, or hay. If you need a straw, bring a reusable one.
4. All disposable food ware packaging must be made from compostable, fiber-based materials. Uncoated, paper-like materials are best. Aluminum is also OK.
5. Plastic, single-use items—even if labeled 1 through 7—are prohibited as food ware, including "Biodegradable" or "Compostable" plastics.
6. The law applies to any restaurant, bar, retail food vendor (such as a grocery store or deli) or food trucks within the City of Alameda.



Questions? Call City of Alameda Public Works
(510) 747-7900 • AlamedaRecycles.org



City of Alameda

Alameda Fire Department
Fire Preventive Services
950 W Mall SQ #140
Alameda, California 94501
510.337.2120 ♦ Fax 510.521.7851



To: Felton Yee, Phyllis M. Trust and Sandra Yee
From: Captain Henderson Assistant Fire Marshal
Re: Approval of Permit number SE20-0053
Date: 11/17/2020

Dear Applicant,

Your special event permit (SE20-0053) for outdoor dining located at 2321 Alameda Ave, from now-10/21/2021 has been approved by the Alameda Fire Department with the following requirements:

-Please have a 20' Fire lane from the North curb out 20'. This lane must be kept clear at all times. Please paint a red line to indicate area to be kept clear the length of the closure.

-Please remove the white plastic barriers. See attached pictures.

Inspector Nathaniel Henderson will conduct an inspection to determine compliance with the approved permit. Please call him at 510-337-2123, not less than 48 hours prior to any fire clearance inspection.

Should you require clarification of the described requirements please contact me at 510-337-2123.

Thank you,

Nathaniel Henderson
Assistant Fire Marshal
510-337-2123

SPECIAL EVENT PERMIT SE20-0053

REPLYREPLY ALLFORWARD

Mark as unread

Deirdre McCartney

Tue 8/4/2020 8:49 AM

To:

office@downtownalameda.com;

Cc:

Debbie Mendoza;

Allen Tai;

1 attachment

Good morning Kathy,

Thank you for submitting your application for the street closure to help support our local businesses. Planning has reviewed and approved your application. The same conditions for the city wide use permit for city owned streets and sidewalks will apply, such as:

- Noise. The use of amplified music, loudspeakers, or generators is not permitted. This use permit does not permit outdoor entertainment within the outdoor areas, including live performances, amplified sound, or electronic displays. All outdoor activity shall comply with the City's Noise Ordinance, AMC Section 4-10.
- Hours of Operation. Outdoor commercial activity consistent with this use permit may occur between the hours of 7AM to 10PM Sunday through Thursday and 7 AM to Midnight on Friday and Saturday.

I have attached a copy of the Resolution PB-20-13 for your information see page 3 for the highlighted section.

Please don't hesitate to contact me if you have any questions.

Best regards and stay well,

Deirdre McCartney, Planning Technician III
Planning, Building + Transportation
2263 Santa Clara Ave. room 190
Alameda, CA 94501
510 747-6814 dmccartney@alamedaca.gov

LEGEND

STRIPING CONSTRUCTION NOTE NUMBER

STRIPING DETAIL NUMBER PER CALTRANS STD PLANS (2018)
ADVANCED STOP LINES

INSTALL NEW TYPE IV (L)/(R) ARROW PER CALTRANS
STANDARD PLAN A24A.

INSTALL NEW TYPE VI LANE DROP ARROW PER
CALTRANS STANDARD PLAN A24A.

INSTALL NEW BUS PAVEMENT MARKING PER CALTRANS
STANDARD PLAN A24E.

INSTALL NEW STOP PAVEMENT MARKING PER CALTRANS
STANDARD PLAN A24D.

INSTALL NEW YIELD LINE (WHITE SERIES OF ISOSCELES
TRIANGLES) PAVEMENT MARKING PER CALTRANS
STANDARD PLAN A24E.

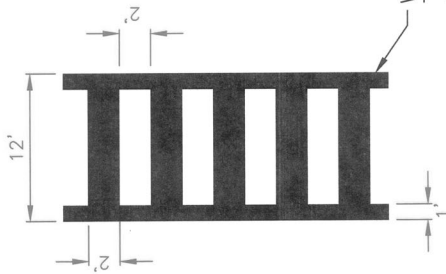

WHITE
THERMOPLASTIC
STRIPE

DETAIL 'A'
NOT TO SCALE

General Notes

- Layout shall be approved prior to striping, pole, and sign installations.
- Use 6" wide striping instead of 4".
- Demo. to be determined with City Engineer/Inspector in the field.
- Parking T's to be determined with City Engineer/Inspector in the field.
- Install K71 bollards 2' from center of any stripe to center of bollard.
- Do not stripe in gutter.

CONSTRUCTION NOTES

- PARKING BUFFER**
Install parking buffer area between extended curb and parking lane. 6" white stripe adjacent to parking lane and extended sidewalk with diagonal 2' white stripes spaced 10' apart toward parking lane.
- ADVANCED STOP LINES**
Install 12" advanced stop line 5' before crosswalk.
- BUS STOP ZONE**
Install bus stop zone. Rectangular 6" stripe border with "BUS" and "STOP" striped per Caltrans Standard Plans A24E and A24D.
- MERGE TRIANGLE**
Install merge triangle with 6" white border and 6" diagonal stripes placed 10' apart.
- PARKING TEES**
Install short stem toward curb, distance measured from center of cross as per City of Oakland Standard details T-7 spaced 22' apart, 8' away from parking buffer.
- YIELD MARKINGS**
Install yield markings, 5' before crosswalk, 36" height, 24" base, spaced 12" apart. Each lane should have its own set of yield markings, centered within that lane, i.e. no triangles should overlap into another lane.
- TURN ARROWS**
Install Type IV (L)/(R) arrows 8 ft from the beginning and 8 ft from the end of turn pockets.
- Crosswalk**
Restripe crosswalk, 12" wide stripe.



APPROVED BY		CITY ENGINEER	
NO.	REVISED	BY	APP.
	DESIGNED AT		
	DRAWN AT		
	CHECKED SW		
	DATE		SCALE
	7/18/20		N.T.S.
CITY OF ALAMEDA		PARK STREET	
		COVID-19 RESTRIPING	
		Lincoln Ave to	
		Encinal Ave	
DATE	7/18/20	SHEET	1 OF 5
DWG.		CASE	

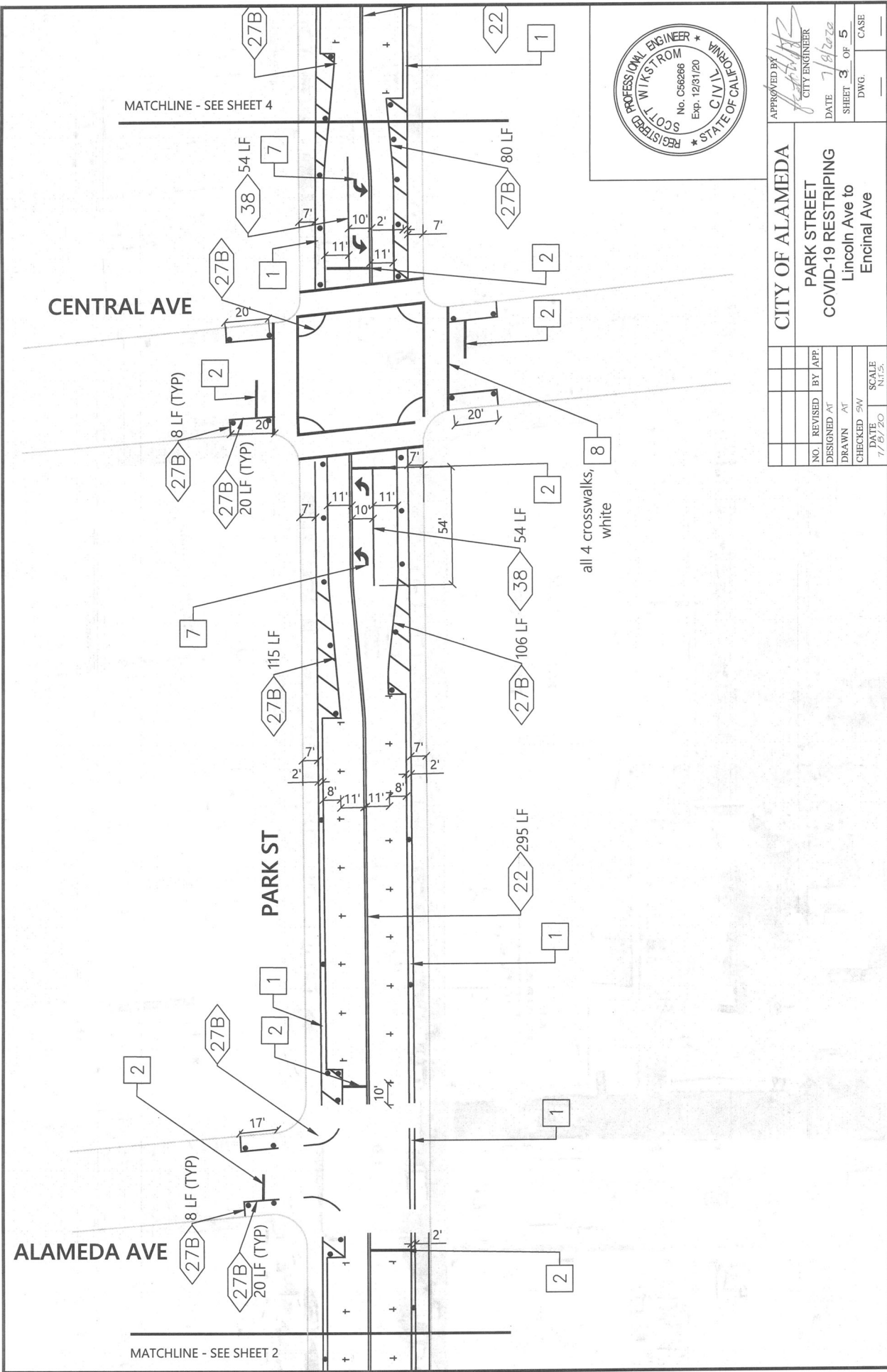

APPROVED BY: *[Signature]*
 CITY ENGINEER
 DATE: 7/19/2020
 SHEET 3 OF 5
 DWG. CASE

CITY OF ALAMEDA	
PARK STREET	
COVID-19 RESTRIPIING	
Lincoln Ave to Encinal Ave	
NO.	REVISD BY /APP.
DESIGNED AT	
DRAWN AT	
CHECKED SW	SCALE
DATE	7/19/20
	N.T.S.

From: [Scott Wikstrom](#)
To: [Eric Levitt](#); [Gerry Beaudin](#)
Cc: [Andrew Thomas](#); [Erin Smith](#); [Donya Amiri](#)
Subject: RE: Webster Street Restripe
Date: Wednesday, July 22, 2020 4:44:00 PM

Thank you.

Yes, I am comfortable with the traffic flow.

Scott Wikstrom

City Engineer
City of Alameda Public Works
510-747-7937

From: Eric Levitt
Sent: Wednesday, July 22, 2020 1:59 PM
To: Scott Wikstrom <swikstrom@alamedaca.gov>; Gerry Beaudin <gbeaudin@alamedaca.gov>
Cc: Andrew Thomas <athomas@alamedaca.gov>; Erin Smith <ESmith@alamedaca.gov>; Donya Amiri <damiri@alamedaca.gov>
Subject: RE: Webster Street Restripe

Are you comfortable with traffic flow. If so, Approved.

From: Scott Wikstrom
Sent: Wednesday, July 22, 2020 1:57 PM
To: Eric Levitt <elevitt@alamedaca.gov>; Gerry Beaudin <gbeaudin@alamedaca.gov>
Cc: Andrew Thomas <athomas@alamedaca.gov>; Erin Smith <ESmith@alamedaca.gov>; Donya Amiri <damiri@alamedaca.gov>
Subject: Webster Street Restripe

Eric,

We are finalizing the striping plans for Webster Street to convert the 4 travel lanes into 2 and allow additional outdoor dining space similar to the work completed on Park Street (see attached). We are seeking your direction before we would move forward with any construction. Based on the Park Street work, I would estimate the construction cost to be from \$40,000 to \$50,000.

The Webster Street restripe would extend from Central to Lincoln Ave based on the input provided by WABA. There are a number of existing planter bulb outs that somewhat limit the amount of outdoor dining space created along this section, but this amount is probably more closely aligned with what would actually be used by the restaurants along the road (also attached).

Both Andrew Thomas and I are supportive of moving forward with the restripe to support the Webster Street businesses and based on the observed functioning of the Park Street striping. Please let either Andrew or I know if you have any questions or would like additional information.

Scott Wikstrom

City Engineer

City of Alameda Public Works

510-747-7937

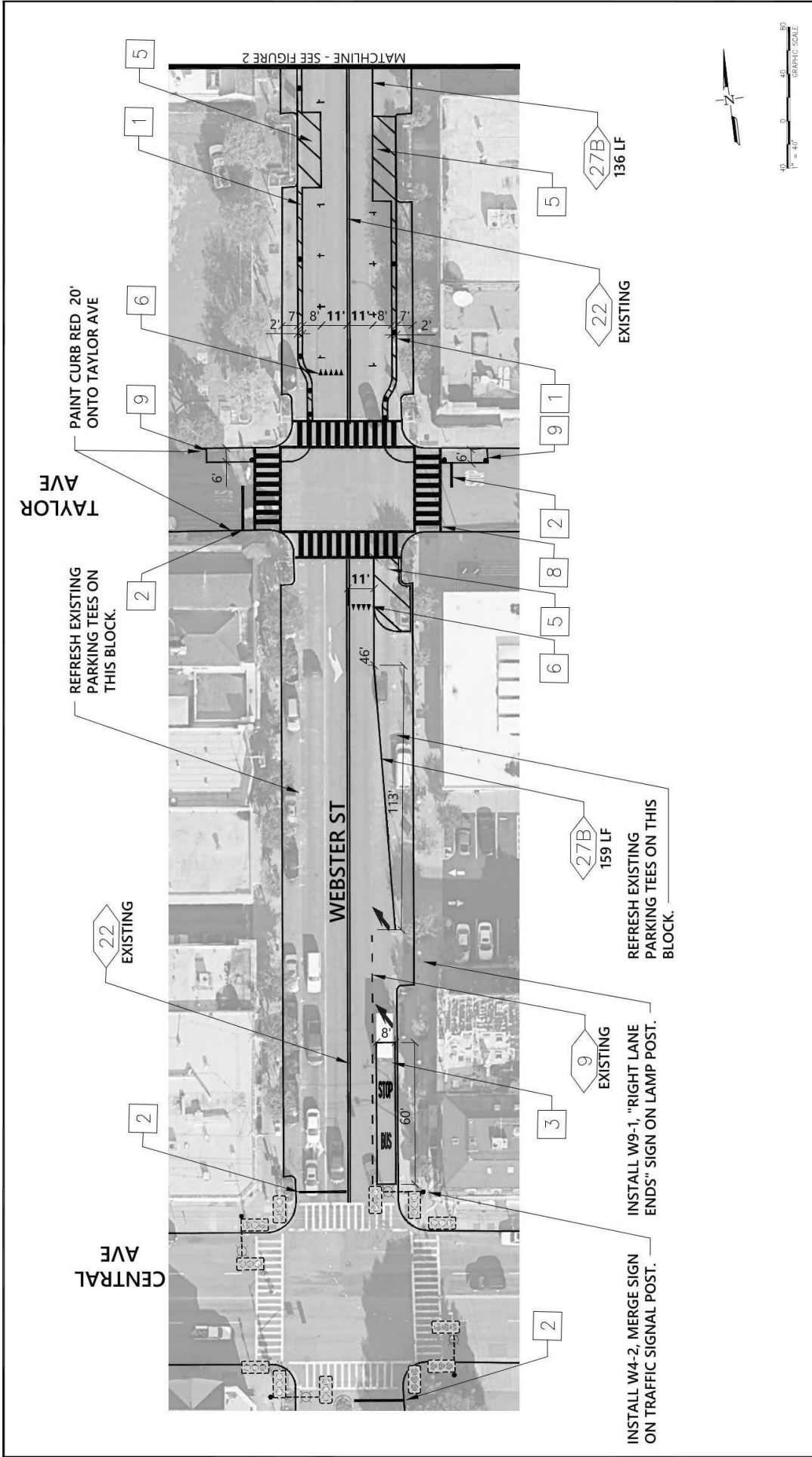

NO.		DESCRIPTION		DATE	BY

FEHR PEERS 2201 Broadway Suite 602 Oakland, CA (510) 834-3200		
--	--	--

CITY OF ALAMEDA WEBSTER STREET COVID-19 RESTRIPIING Central Ave to Pacific Ave		APPROVED BY CITY ENGINEER DATE SHEET 2 OF 4 DWG. CASE
---	--	---

NO.	REVISED	BY	APP.	DATE	SCALE

TAYLOR
AVE

CENTRAL
AVE

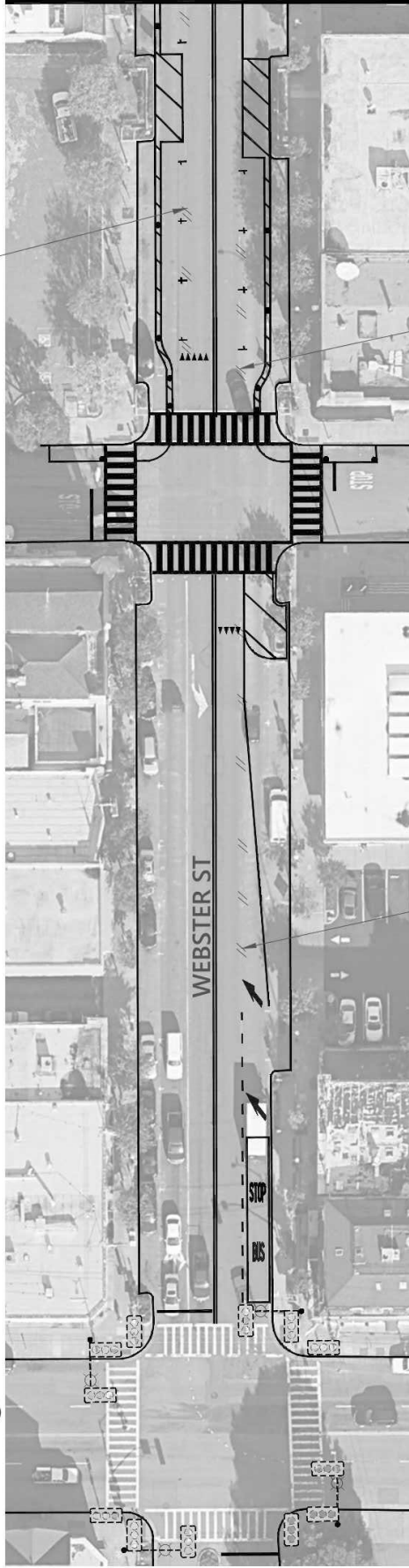

REMOVE EXISTING LANE
STRIPES ON ENTIRE BLOCK

REMOVE EXISTING LANE
STRIPES ON ENTIRE BLOCK

REMOVE EXISTING LANE STRIPES
NORTH OF PARKING LOT EGRESS

MATCHLINE - SEE FIGURE 2

NO.		DESCRIPTION		DATE	BY

FEHR PEERS 2201 Broadway Suite 602 Oakland, CA (510) 834-3200		
REVISIONS		

CITY OF ALAMEDA WEBSTER STREET COVID-19 RESTRIPING REMOVAL PLAN Central Ave to Pacific Ave	APPROVED BY CITY ENGINEER DATE SHEET 1 OF 3 DWG. CASE
--	---

NO.	REVISED	BY	APP.
DESIGNED	J.K.		
DRAWN	J.K.		
CHECKED	R.E.		
DATE	07/7/20	SCALE	1/4" = 1'-0"

Slow Streets Alameda – Phase IA, Pilot Additional Signage

Location 1a, Versailles Avenue: at Santa Clara Ave and at Buena Vista Ave



Example Closure placed to close 1/2 of the roadway @ back of crosswalk or even w/ back of sidewalk

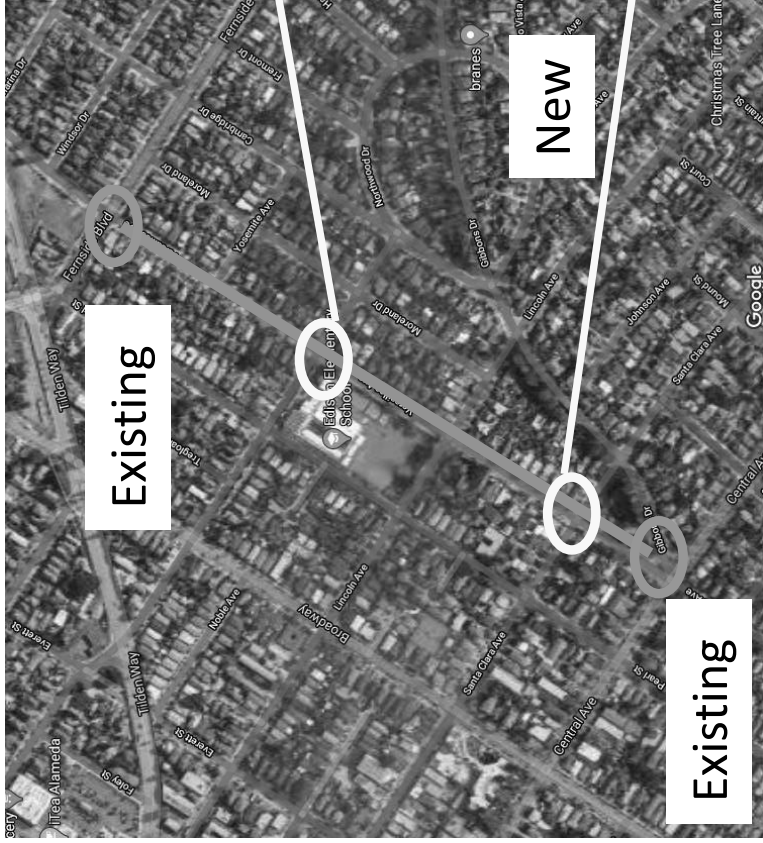

Versailles at Buena Vista Ave
2 closures



Versailles at Santa Clara Ave
2 closures

Slow Streets Alameda – Phase IA Additional Signage

Location 2, Pacific Avenue: Oak St to Grand St



Example Closure placed to close 1/2 of the roadway @ back of crosswalk or even w/ back of sidewalk



Pacific and Chestnut
2 Closures



Pacific and Walnut
2 Closures

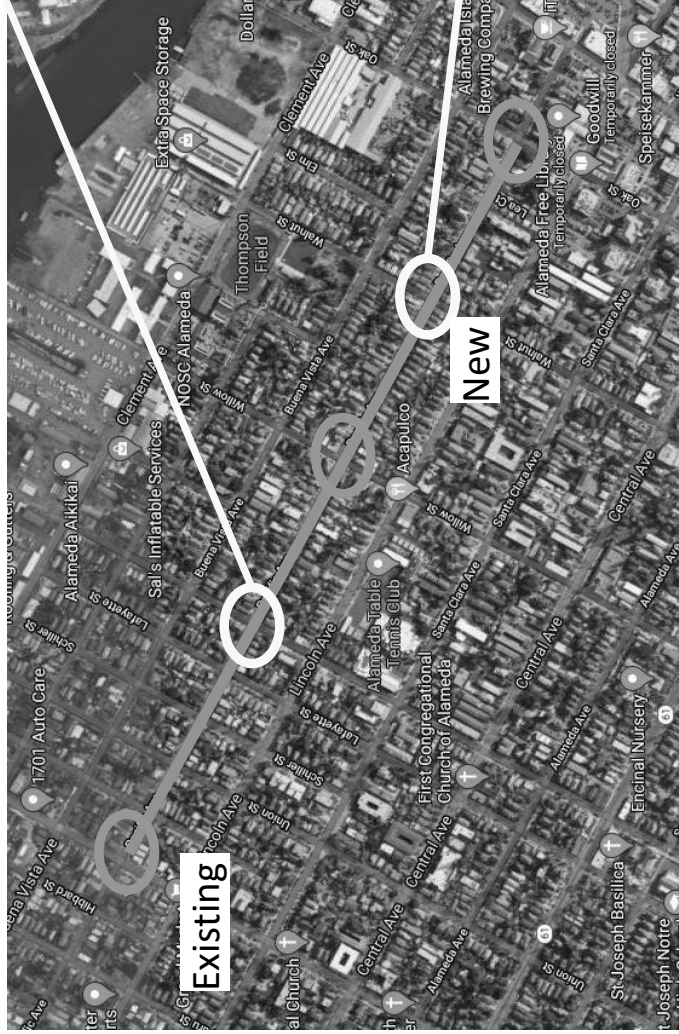

Slow Streets Alameda – Phase 2

Edited By: Brian McGuire 5/5/20
 Approved by Scott Wikstrom



Location 3, Pacific Avenue: Eighth St to Grand St

Example Closure placed to close 1/2 of the roadway @ back of crosswalk or even w/ back of sidewalk

Pacific and Ninth
 1 Closure



Pacific and St. Charles
 2 Closures



Pacific & Sherman
 2 Closures



Pacific & Benton
 1 Closure



Pacific & Paru
 2 Closures

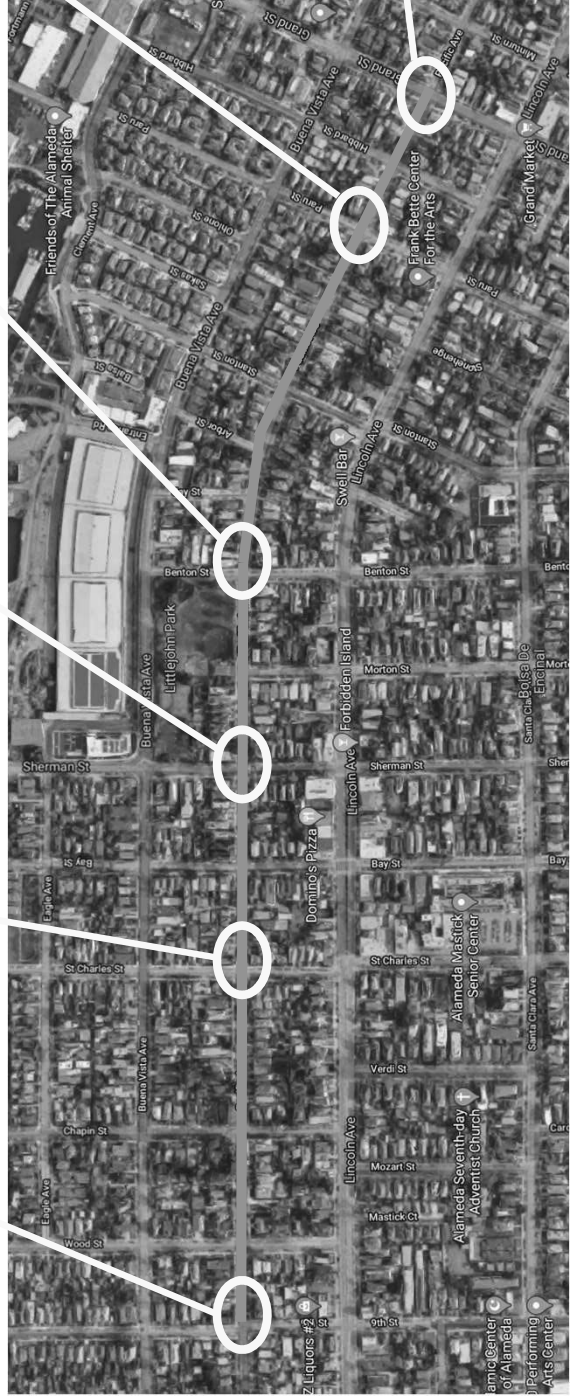

Pacific & Grand
 1 (new) Closure



Slow Streets Alameda – Phase 2

Location 4, Santa Clara Avenue: Pacific to Sixth

Pacific & Santa Clara
1 Closure



Santa Clara & Third
2 Closures



Santa Clara & Fifth
2 Closures



Santa Clara & Sixth
1 Closure



Example Closure placed to close 1/2 of the roadway @ back of crosswalk or even w/ back of sidewalk



Edited By: Brian McGuire 5/5/20
Approved by Scott Wikstrom



Slow Streets Alameda – Phase 1B Additional Signage

Edited By: Brian McGuire 6/15/20

Location Pacific Avenue at Schiller Street



Example Closure placed to close 1/2 of the roadway @ back of crosswalk or even w/ back of sidewalk

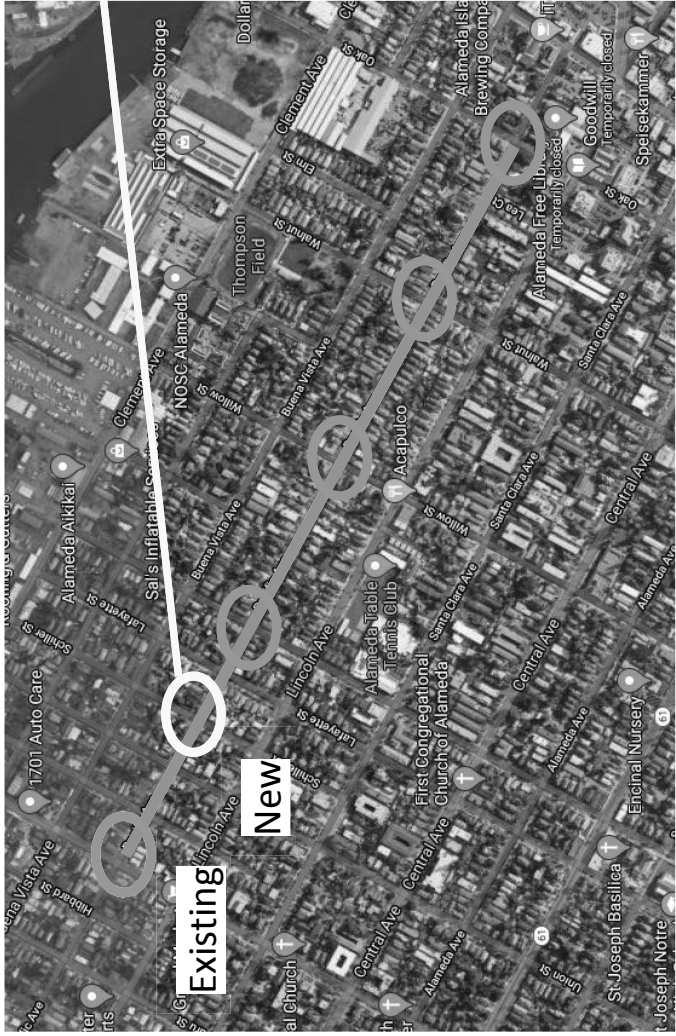

Pacific and Schiller
2 Closures

Slow Streets Alameda – Phase 2A Additional Signage

Edited By: Brian
McGuire 6/15/20

Location 4, Santa Clara Avenue: Pacific to Sixth



Santa Clara & Fourth
2 Closures



Example Closure placed to close 1/2 of the roadway
@ back of crosswalk or even w/ back of sidewalk



Slow Streets Alameda – Phase 3

Edited By: Brian
McGuire 6/15/20



Location 5, San Jose Avenue: Morton/San Antonio to Oak

Example Closure placed to close 1/2 of the roadway @ back of crosswalk or even w/ back of sidewalk

Morton & San Antonio
1 Closure (SOUTH)



San Jose & Paru
1 Closure (WEST)



San Jose & Grand
2 Closures

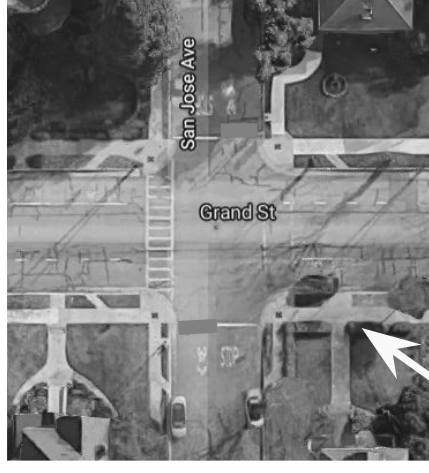

Slow Streets Alameda – Phase 3

Edited By: Brian McGuire 6/15/20



Location 5, San Jose Avenue: Morton/San Antonio to Oak

Example Closure placed to close 1/2 of the roadway @ back of crosswalk or even w/ back of sidewalk

San Jose & Lafayette
1 Closure (WEST)



San Jose & Chestnut
1 Closure (EAST)



San Jose & Willow
2 Closures



San Jose & Oak
1 Closure (WEST)



Slow Streets Alameda – Phase 3

Location 6, Versailles Avenue: Central to Otis



<<< Versailles & Central
1 Closure (SOUTH)



<<< Versailles & Encinal
2 Closures



<<< Versailles & San Jose
2 Closures



<<< Versailles & Otis
1 Closure (NORTH)



Edited By: Brian
McGuire 6/15/20

Example Closure placed to close 1/2 of the roadway @ back of crosswalk or even w/ back of sidewalk