

# City of Alameda

## Clement Avenue / Tilden Way Improvement Project



Alameda Unified School District – City of Alameda Subcommittee  
September 10, 2025



# Agenda

- Location and Overview
- Timeline
- Construction Impacts
- Construction Outreach

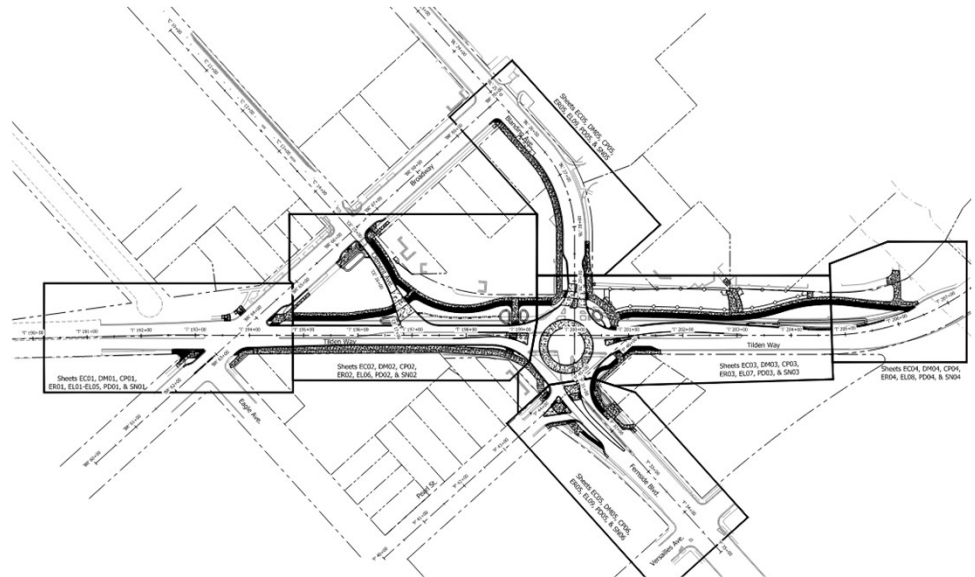

# Location

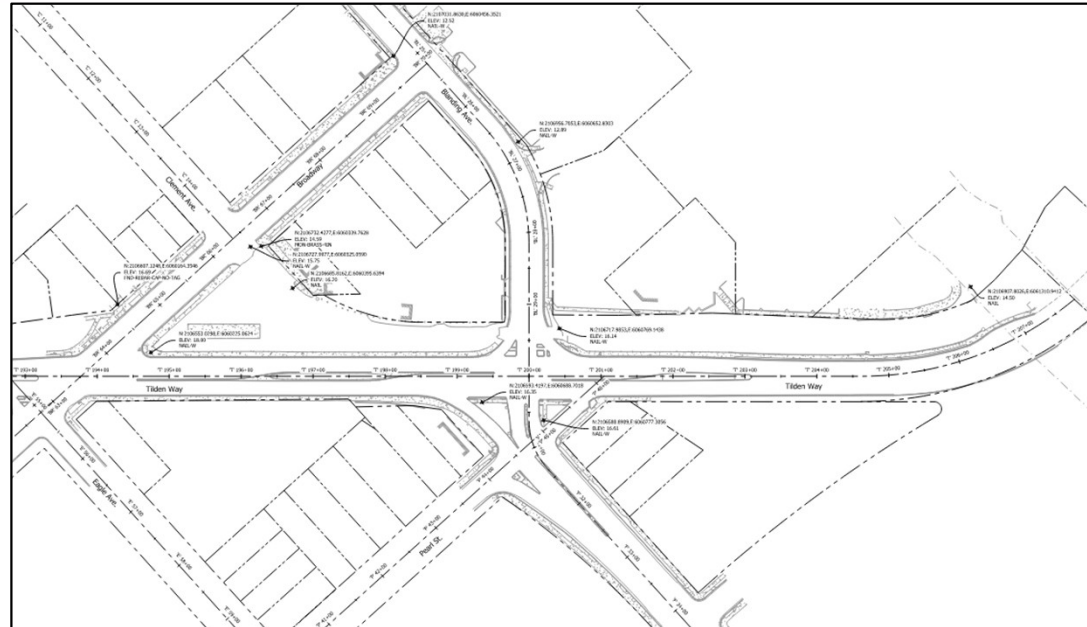



# Overview

## Project Goals and Intended Outcomes

- Prioritize **safety**
- Improve **mobility** for all roadway users
- Improve **bicycle and pedestrian** access
- Provide **landscaping** opportunities
- **Reduce greenhouse gas** emissions
- **Comply** with City plans and policies

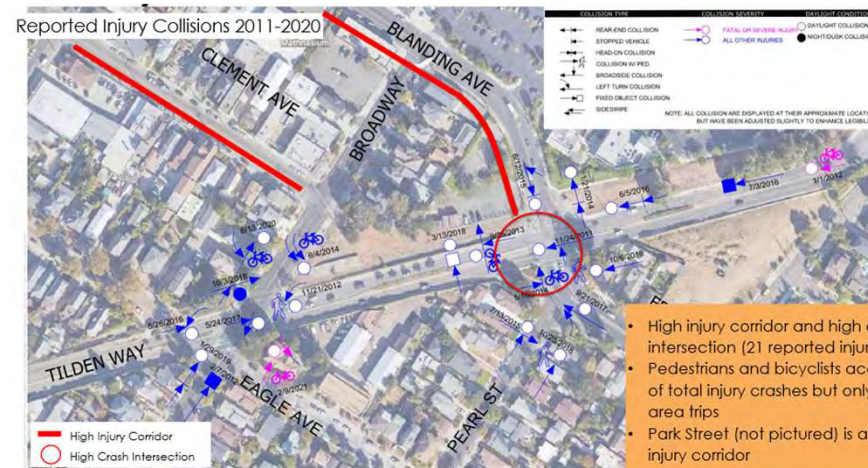

- High injury corridor and high crash intersection (21 reported injury crashes)
- Pedestrians and bicyclists account for 38% of total injury crashes but only 9% of study area trips
- Park Street (not pictured) is a Tier 1 high injury corridor



# Project Overview

## **Project Scope (includes but not limited to)**

- Cross Alameda Trail gap closure at Clement Avenue
- SF Bail Trail Connection
- Roundabout at Tilden/Blanding/Fernside Intersection
- Road diet at Tilden Way with vehicle travel lane reductions
- Clement Avenue extension between Tilden and Broadway
- Landscape Improvements
- Dog Park Construction
- Bike/Pedestrian improvements at Tilden Way/Broadway
- Bicycle/Pedestrian improvements and paths
- Rail platform/track removal

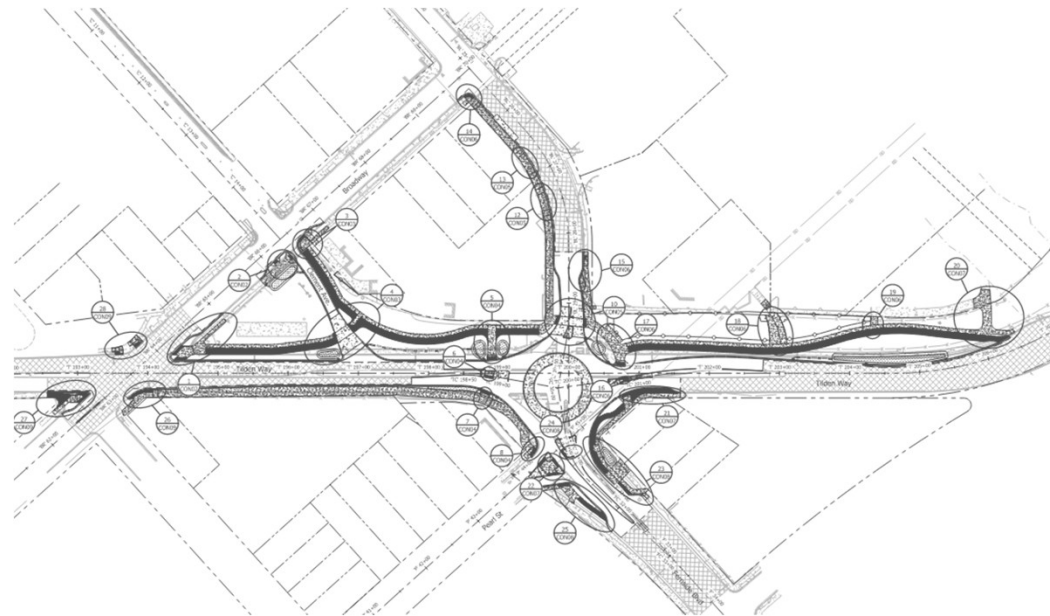

# Timeline

## WHERE WE'VE BEEN

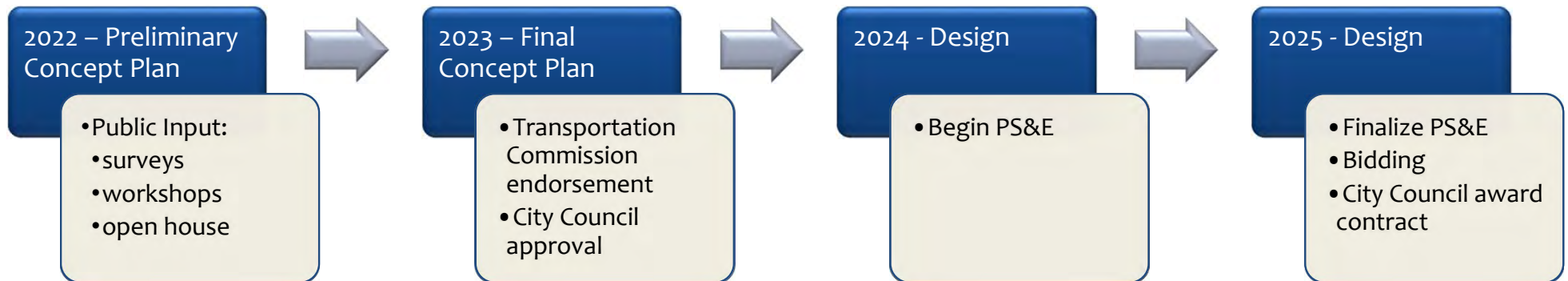

## WHERE WE'RE GOING

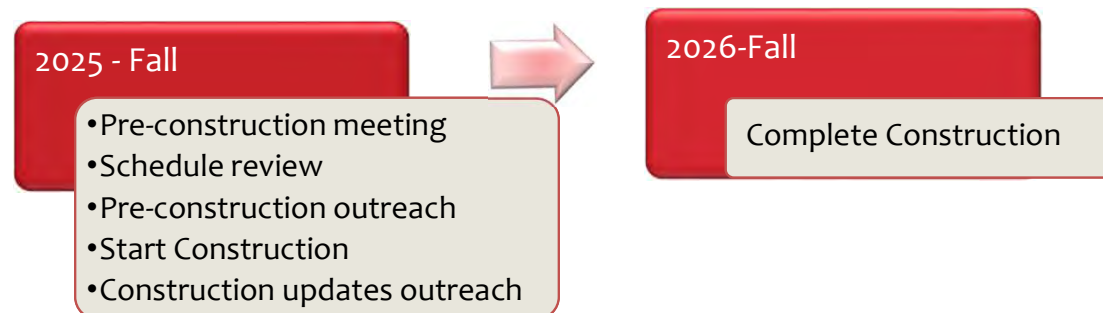

# Construction Impacts – Stage 1

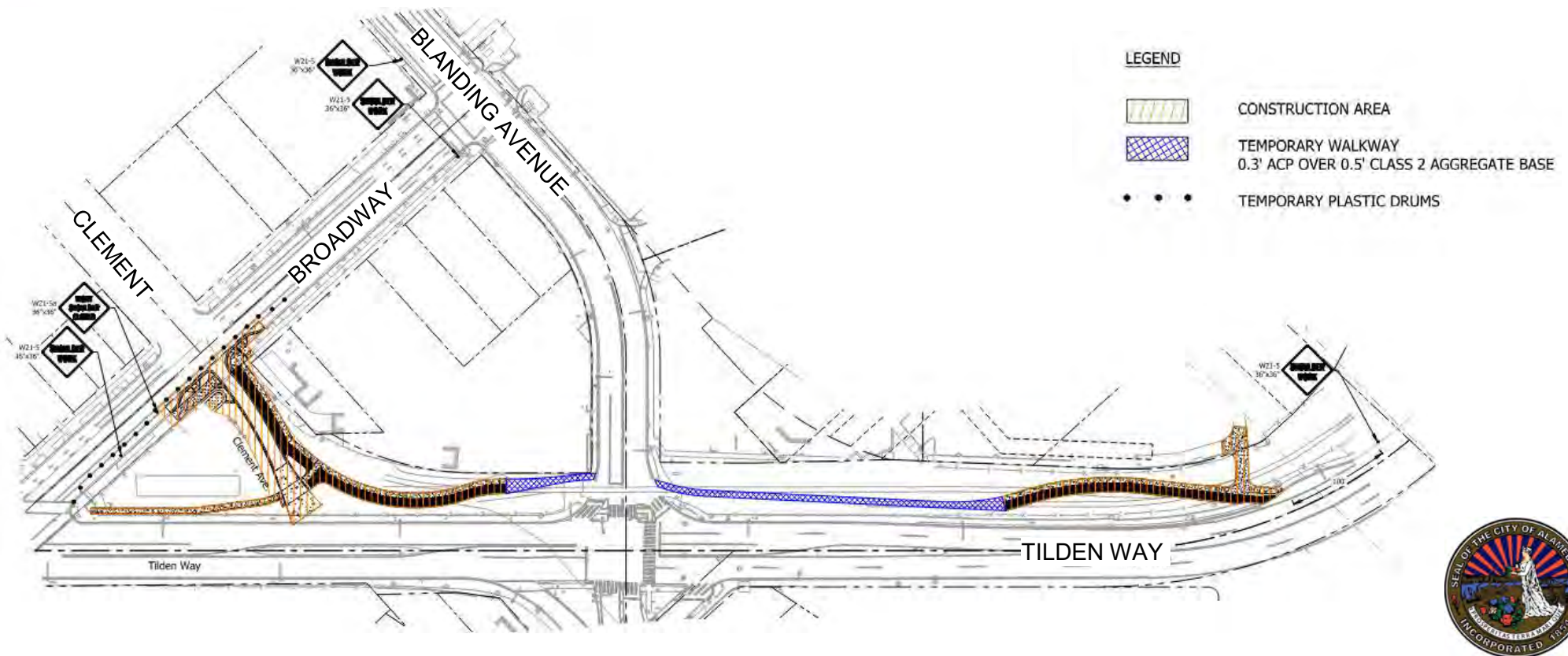



# Construction Impacts – Stage 2

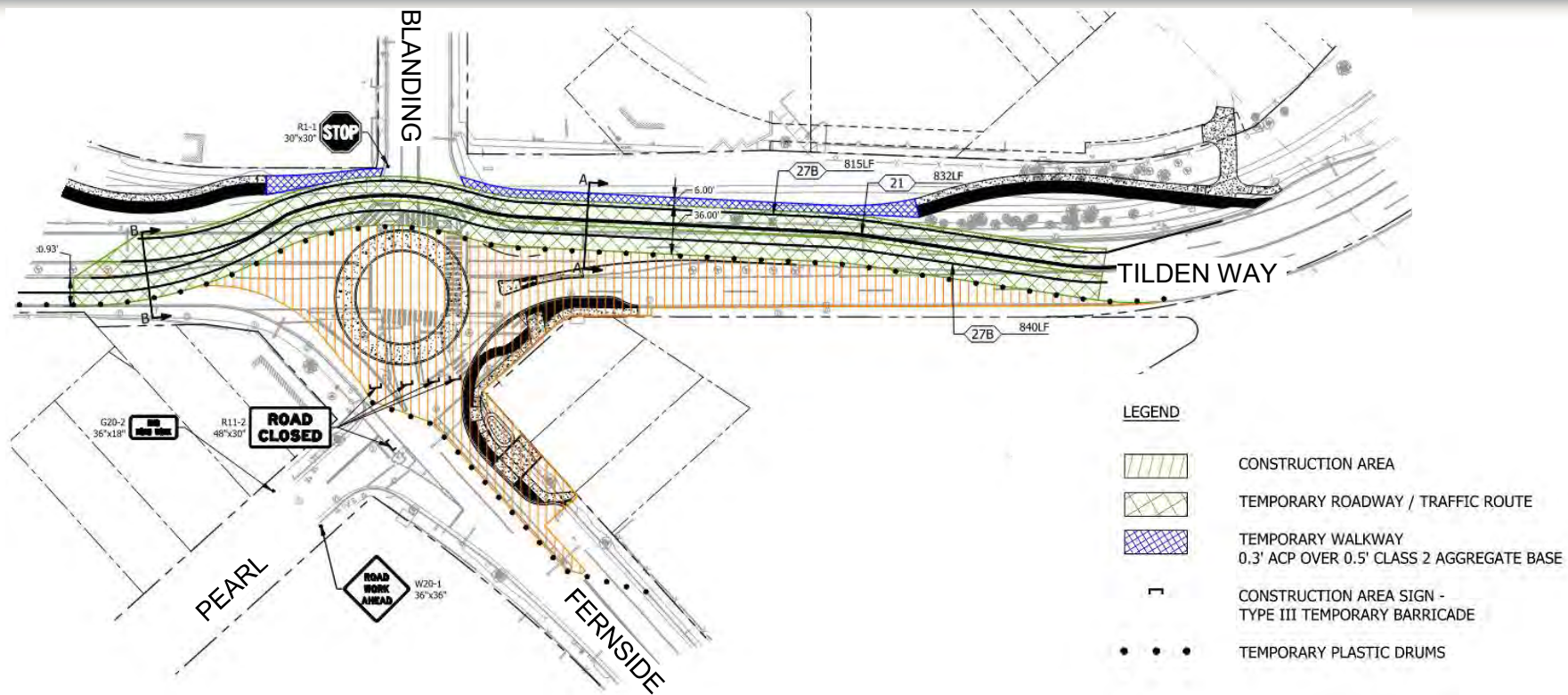



# Construction Impacts

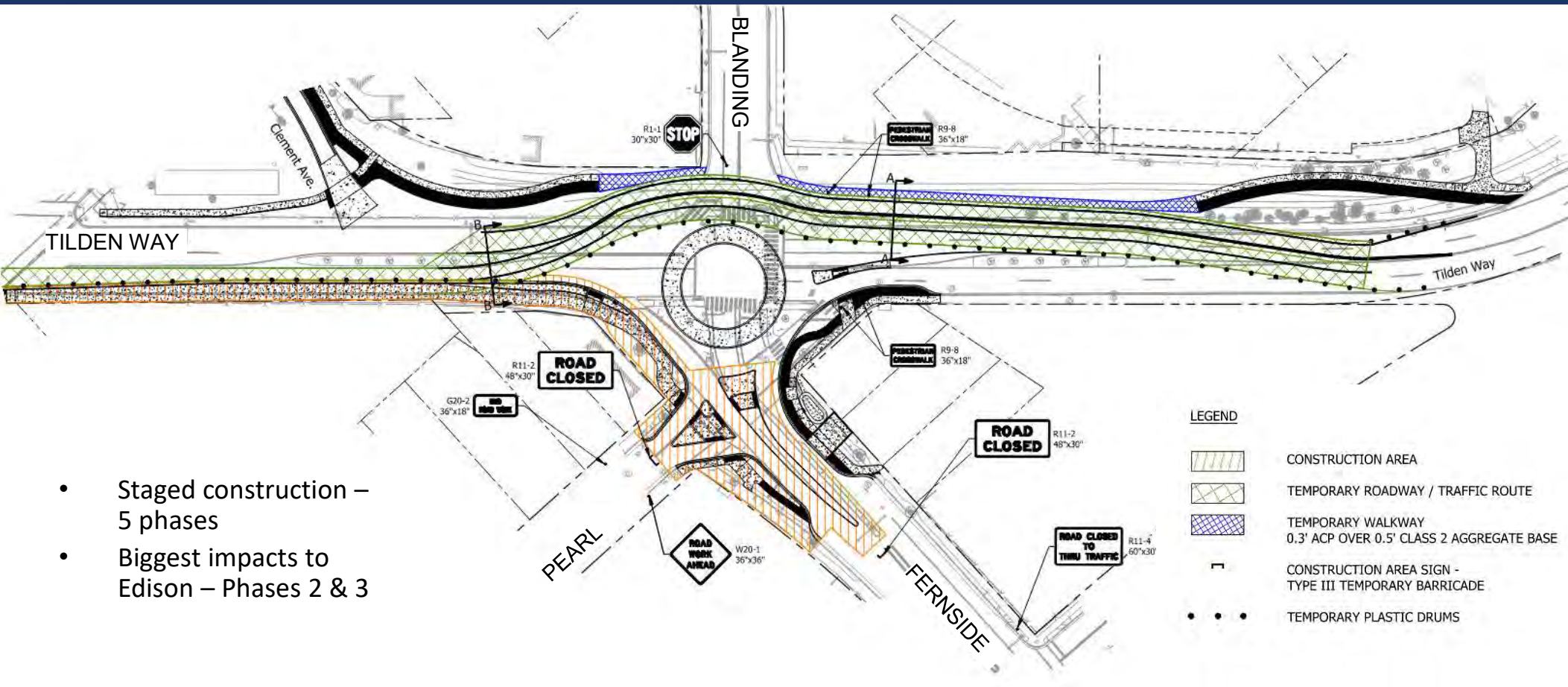

# Construction Impacts – Stage 4

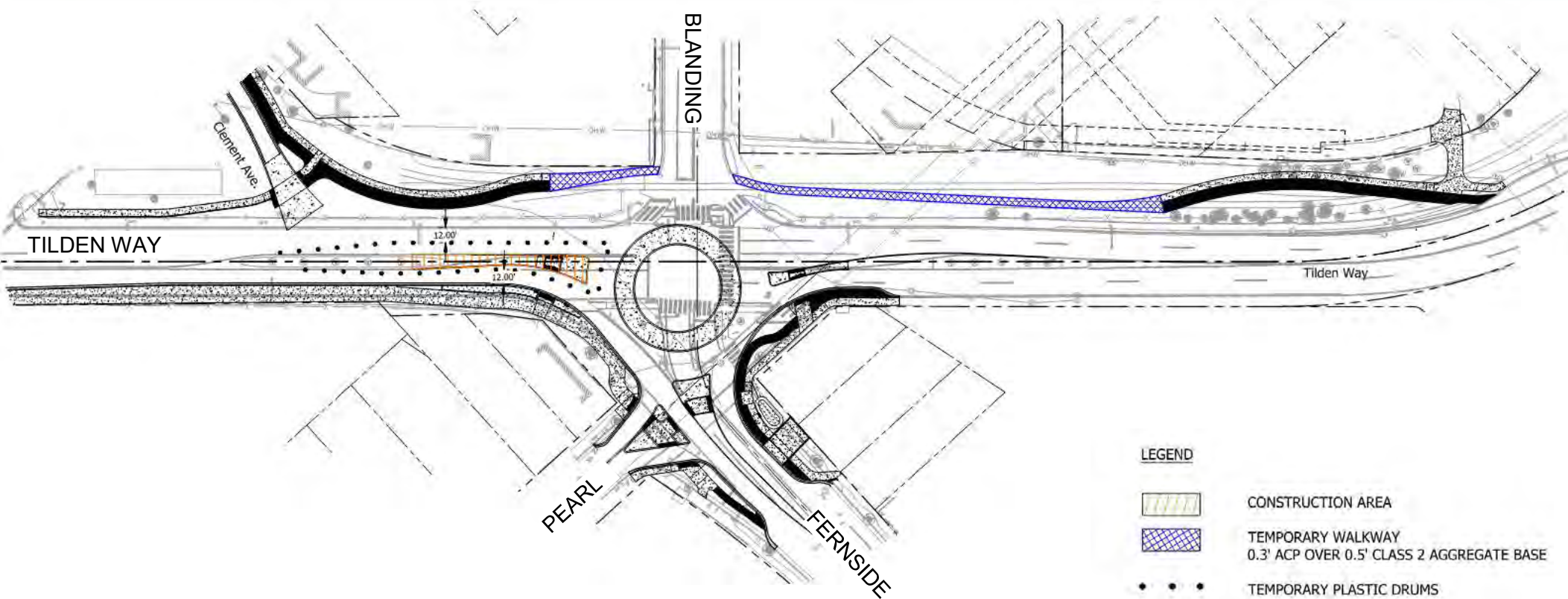



# Construction Impacts – Stage 5

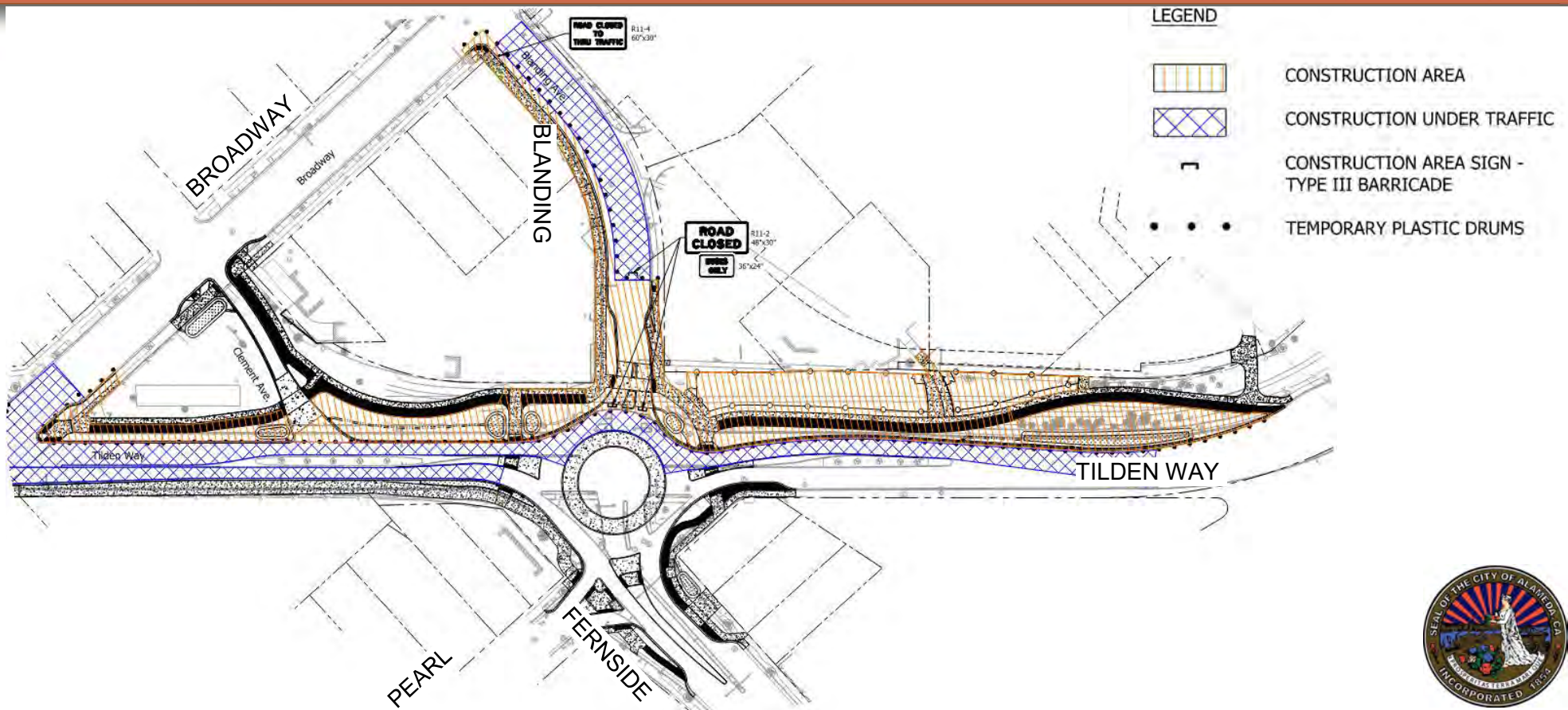



# Citywide/AUSD Impacts

## City Impacts/AUSD During Phases 2 & 3

- Local traffic to detour at Versailles/Buena Vista when Fernside is closed
- Electronic Message Board Signs ( [REDACTED] ) will encourage city/island wide traffic to use Encinal Avenue when Fernside is closed
- Close coordination with Edison Elementary/AUSD on school traffic routing



# Impacts at Edison



- Staged construction – 5 phases
- Biggest impacts to Edison – Phases 2 & 3
- Local traffic to detour at Versailles > Buena Vista when Fernside is closed
- CMS Signage - Island-wide Traffic encouraged to use High > Encinal
- Close coordination with Edison Elementary/AUSD on school traffic routing and schedule





# Impacts at Lincoln



- Island-wide traffic encouraged to use Otis > High > Encinal during Fernside closure
- CMS Signage - Detoured traffic to avoid Fernside and Lincoln Middle School





# Recent and Upcoming Outreach

## City

- Meeting with AUSD Construction Manager and Edison Principal: **September 4**
- Letters/Mailers to Businesses/Property Owners/Residents within 300ft of the work area and detours: **September 10**
- Virtual Open House Meeting: **September 30**
- Meet with businesses at Bridgeside Shopping Center
- Construction/Schedule Updates on Project Website
- Press Releases/Social Media
- Monthly Email updates to stakeholders

## Contractor

- Hand deliver notices to impacted businesses/residents
- Parking restriction signage, with dates/hours
- Notify area services (AC Transit, ACI, Emergency, USPS)

