

Annexation Map No. 1 of the City of Alameda Community Facilities District No. 13-2 (Alameda Landing Public Improvements), City of Alameda, County of Alameda, State of California.

Reference is hereby made to that certain map entitled "Map of Proposed Boundaries of City of Alameda Community Facilities District No. 13-1 (Alameda Landing Public Improvements), City of Alameda, County of Alameda, State of California," filed the 12th day of December, 2013, at the hour of 10:29 a.m. in Book 18 of Maps of Assessment and Community Facilities District at Page 45, (document no. 2013382195) in the office of the County Recorder of the County of Alameda, State of California, which this Annexation Map affects.

LEGEND

----- INDICATES BOUNDARY OF PROPOSED TERRITORY TO BE ANNEXED

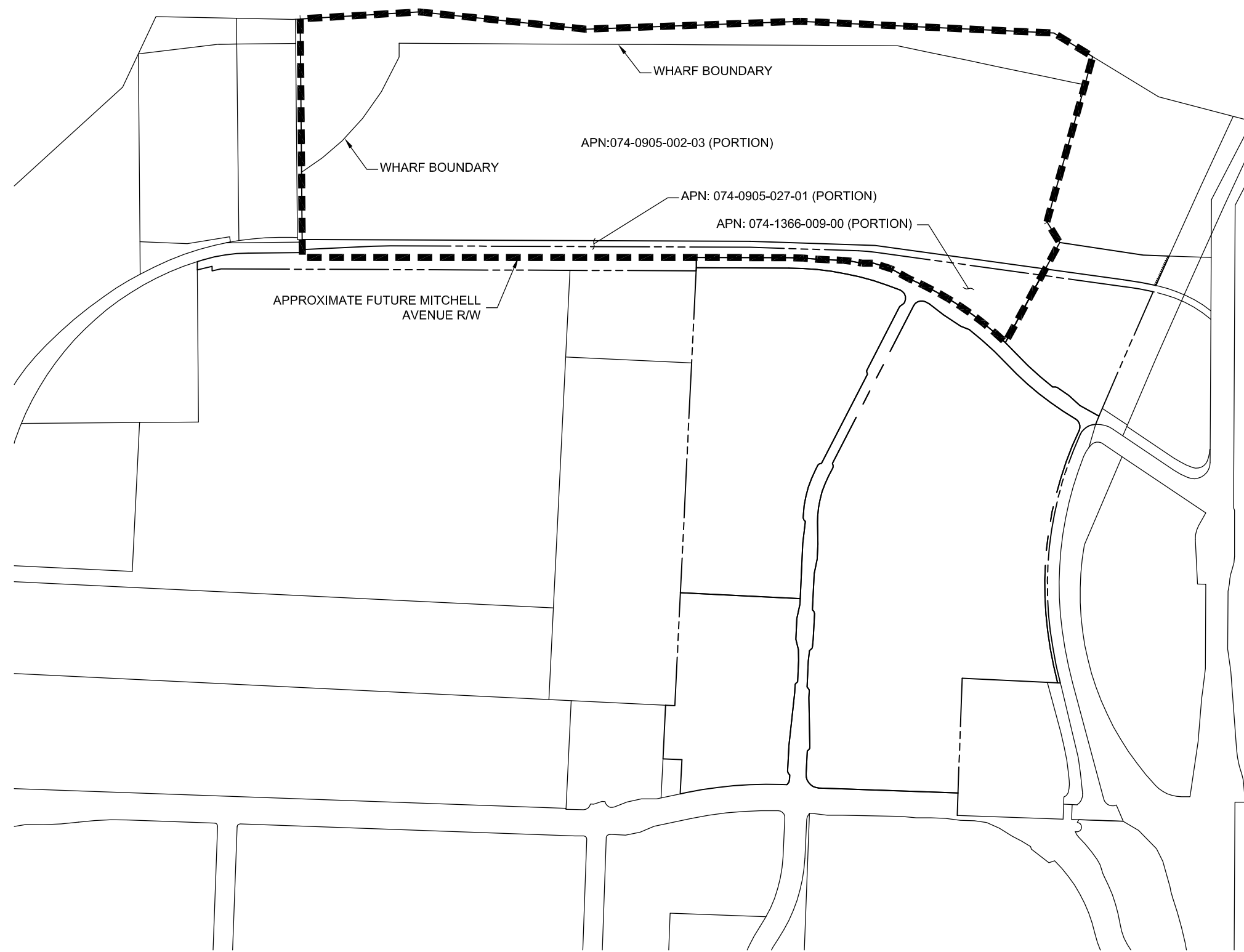

THE TERRITORY TO BE ANNEXED INCLUDES PORTIONS OF ASSESSOR'S PARCELS: 074-0905-002-03, 074-0905-027-01 AND 074-1366-009-00, AS FURTHER DESCRIBED AS:

[PROPERTY DESCRIPTION TO BE INSERTED HERE WHEN READY.]

1. Filed in the office of the City Clerk of the City of Alameda this ____ day of _____, 2015.

By: _____
City Clerk

2. I hereby certify that the within map showing proposed boundaries of Annexation No. 1 to the City of Alameda Community Facilities District No. 13-1 (Alameda Landing Public Improvements), City of Alameda, County of Alameda, State of California, was approved by the City Council of the City of Alameda at a meeting thereof, held on the __ day of _____, 2015, by its Resolution No. ____.

By: _____
City Clerk

3. Filed this ____ day of _____, 2015, at the hour of ____ o'clock __m., in Book ____ of Maps of Assessment and Community Facilities Districts at Page ____ in the office of the County Recorder for the County of Alameda, State of California.

By: _____
County Recorder,
County of Alameda

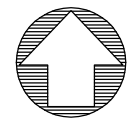

GRAPHIC SCALE



400 0 400 800