

ALAMEDA AQUATIC CENTER

Recreation & Park Commission

September 12, 2024





Alameda Aquatics

TODAY

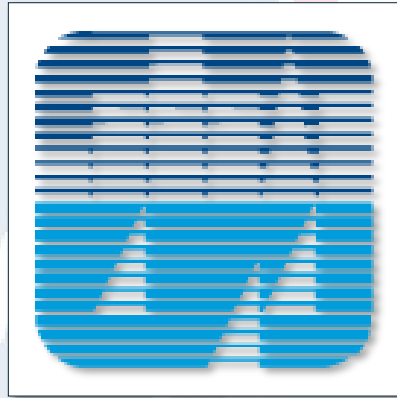
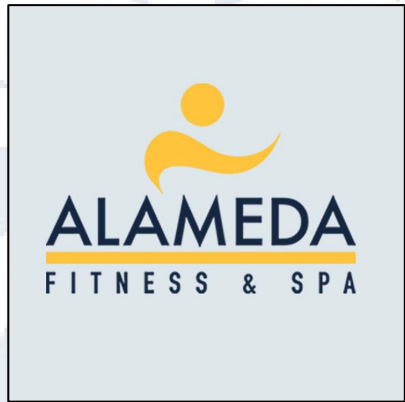
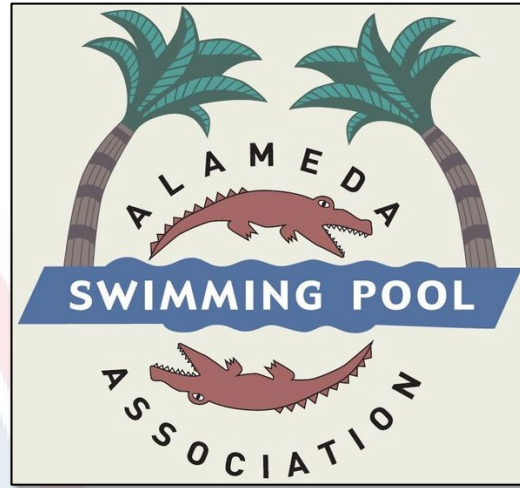

The background features a large, faded circular seal of Alameda County. The seal contains a central figure holding a heart, with the word "ALAMEDA" written below it and a star at the bottom. The text "Community Engagement" is overlaid in large blue font across the seal.

Community Engagement

ALAMEDA

PROCESS

COMMUNITY ENGAGEMENT PROCESS

- **JOINT SESSION CITY COUNCIL/RECREATION AND PARK COMMISSION**
- **WORKSHOP #1**
- **ENCINAL POOL SWIM LESSON OUTREACH**
- **SITE VISITS ARPD RAP PROGRAMS**
- **MASTICK SENIOR CENTER**
- **WORKSHOP #2**
- **WORKSHOP #3**

MAY 13, 2024
MAY 18, 2024
MAY 26, 2024
MAY 29, 2024
MAY 29, 2024
JUN 08, 2024
AUG 03, 2024





ARPD/Seniors After School Programs

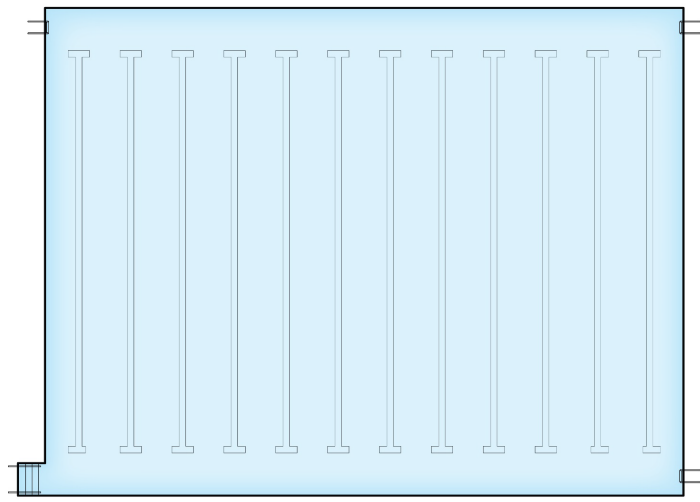

30 Meter x 25 Yard Pool

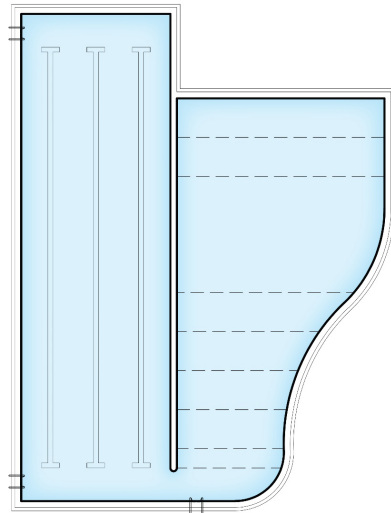

Activity Pool

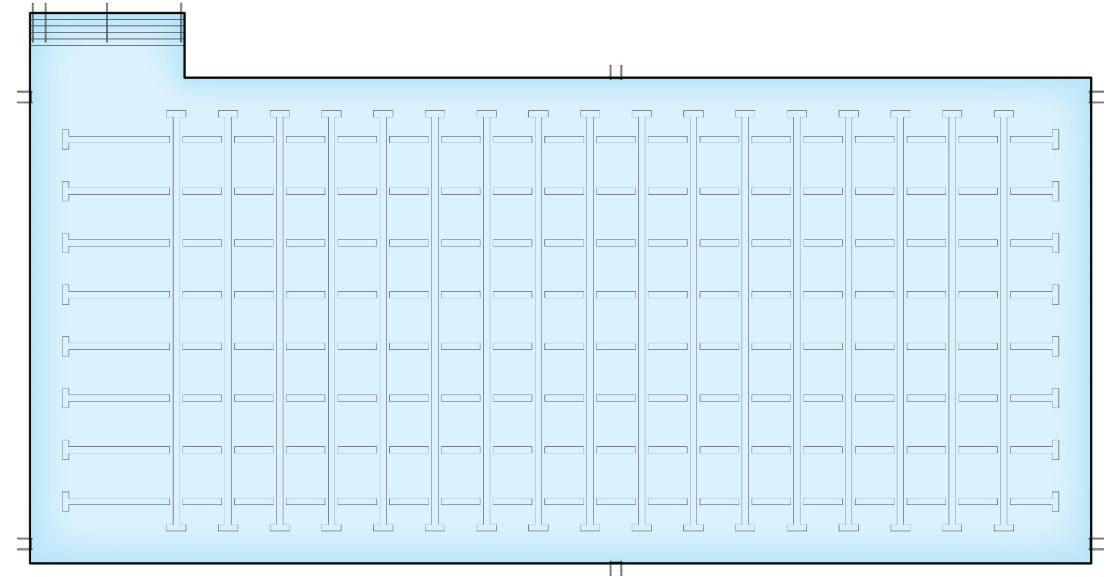

50 Meter x 25 Yard Pool

2 Pools / Single 50m ?

Survey Tracking CONFIDENTIAL	Saturday 18-May	Monday 20-May	Tuesday 21-May	Tuesday 21-May	Wednesday 22-May	Wednesday 22-May	Wednesday 22-May	Thursday 23-May	Thursday 23-May	Friday 24-May
Alameda Aquatic Center FINAL RESULTS - Updated May 24 at 9:35pm	Workshop	2pm	1pm	7pm	9am	1pm	7pm	9am	7pm	7pm
Number of Respondents	48	320	630	805	972	1064	1110	1169	1251	1336
If the new Alameda Aquatic Center had a competitive pool and a fun-water pool, which would you use most?										
Competition Pool	16%	41%	42%	44%	44%	44%	44%	44%	43%	45%
Activity Pool		59%	58%	56%	56%	56%	56%	56%	57%	55%
Which pool type do you think is the most important to the community?										
Competition Pool	16%	32%	37%	38%	38%	38%	38%	38%	37%	39%
Activity Pool	84%	64%	63%	62%	62%	62%	62%	62%	63%	61%
Where should the front door be located- to the west near Wilma Chan / Atlantic Intersection, or to the east at the park interior?										
East							66%	66%	65%	65%
West		34%	35%				34%	34%	35%	35%
Which is your preferred concept for the new Alameda Aquatic Center (50M Pool Question)										
East "A" - Two Pools	35%	50%	50%	50%	49%	49%	49%	49%	49%	49%
East "B" - Single 50m Pool	15%	16%	15%	15%	16%	15%	15%	15%	14%	14%
West "A" - Two Pools	35%	26%	25%	24%	24%	25%	26%	26%	26%	25%
West "B" - Single 50m Pool	15%	8%	10%	11%	11%	11%	11%	11%	11%	12%

3,000 +

RESPONSES

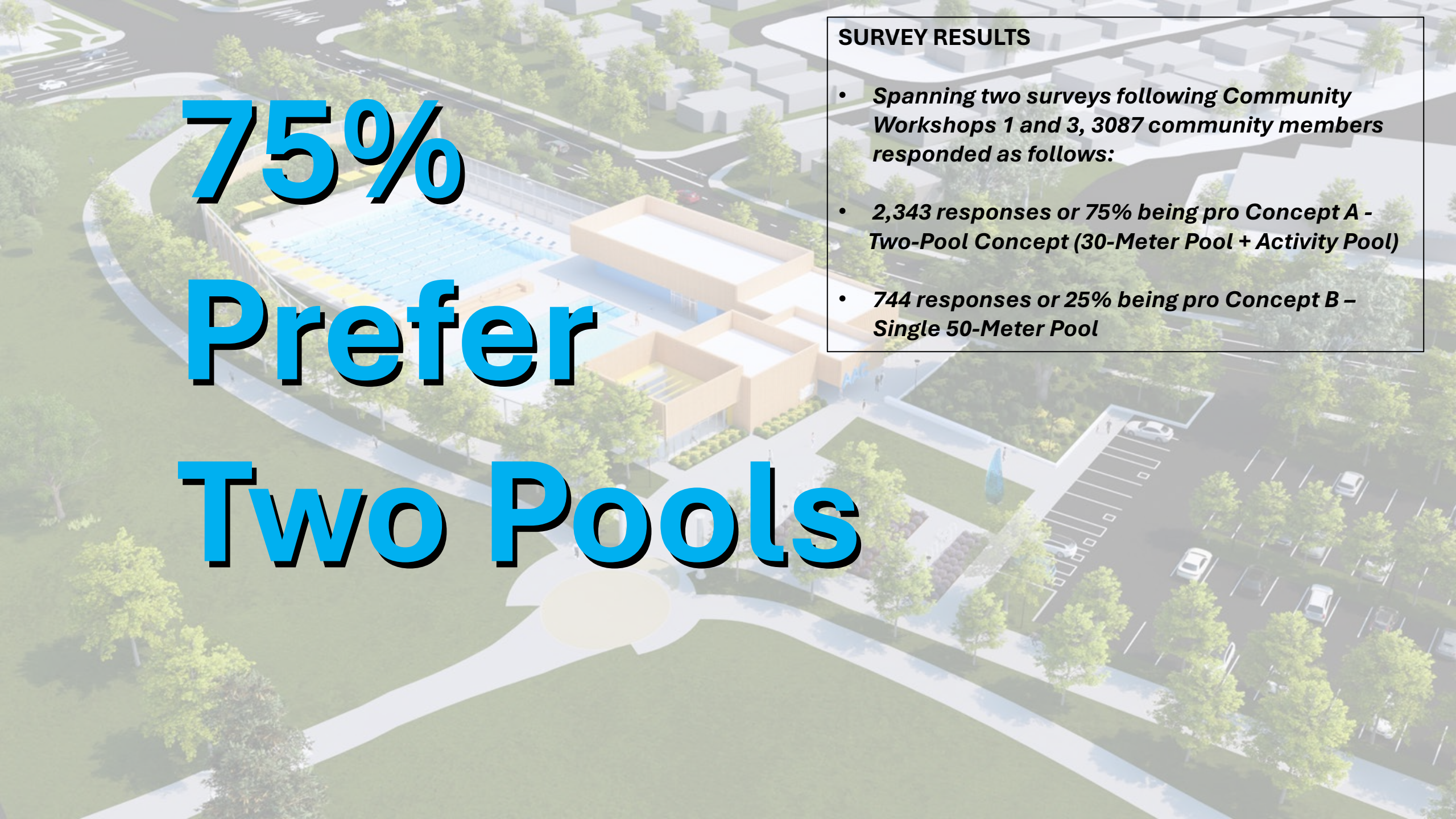
An architectural rendering of a modern community center building with two swimming pools. The building is a long, low-profile structure with a light-colored facade and large windows. One pool is a large, rectangular lap pool with lane markers, and the other is a smaller, more irregularly shaped pool. The building is surrounded by greenery, trees, and a parking lot with several cars. The overall scene is bright and sunny.

75%

Prefer

Two Pools

SURVEY RESULTS

- *Spanning two surveys following Community Workshops 1 and 3, 3087 community members responded as follows:*
- *2,343 responses or 75% being pro Concept A - Two-Pool Concept (30-Meter Pool + Activity Pool)*
- *744 responses or 25% being pro Concept B - Single 50-Meter Pool*

The background features a large, semi-transparent seal of Alameda County. The seal is circular with a light blue center and a pinkish-red outer ring. In the center of the seal is a white anchor with a heart shape above it. Below the anchor, the word "ALAMEDA" is written in white capital letters. The seal is partially obscured by the large blue text.

Community Garden

POSSIBLE SITES



**ARPD has committed up to \$400,000 toward the Community Garden
October 4, 2024 KICK-OFF SESSION**

With
Our Alameda Community
Alameda Backyard Growers
and
Friends of Jean Sweeney Open Space Park Fund

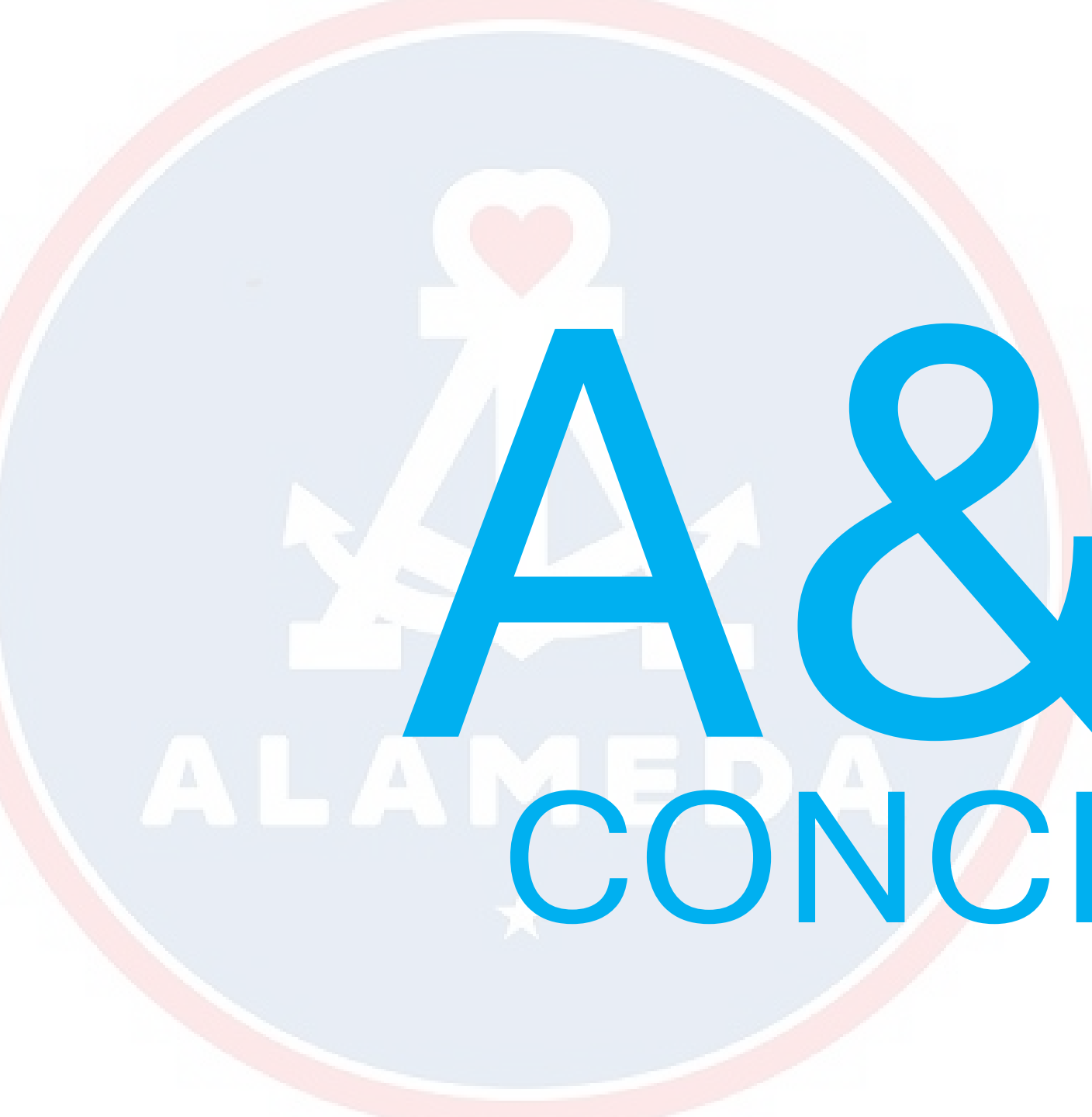

A & B

CONCEPTS



THE SITE WILL REQUIRE APPROXIMATELY \$1 MILLION FOR SOILS IMPROVEMENT AND GROUND WATER

Design and Engineering Issue – Impacts both Concepts



SOILS IMPROVEMENT

A

B

Project Budget

\$31.5MM

\$32.2MM

Soils Improvement

(\$ 1.0MM)

(\$ 1.0MM)

Increased Budget

\$32.5MM

\$33.2MM

SOILS IMPROVEMENT

COVERING THE COST OF SOIL IMPROVEMENT

- **Outdoor Pavilion in lieu of Multipurpose Room** **\$500K**
- **Open-Air Breezeway in lieu of Lobby** **\$200K**
- **Fenced Storage Area in Lieu of Storage Building** **\$200K**
- **Eliminate Diving Well and Springboards** **\$100K**

\$1M



A

30-METER POOL
ACTIVITY POOL



\$31.5MM

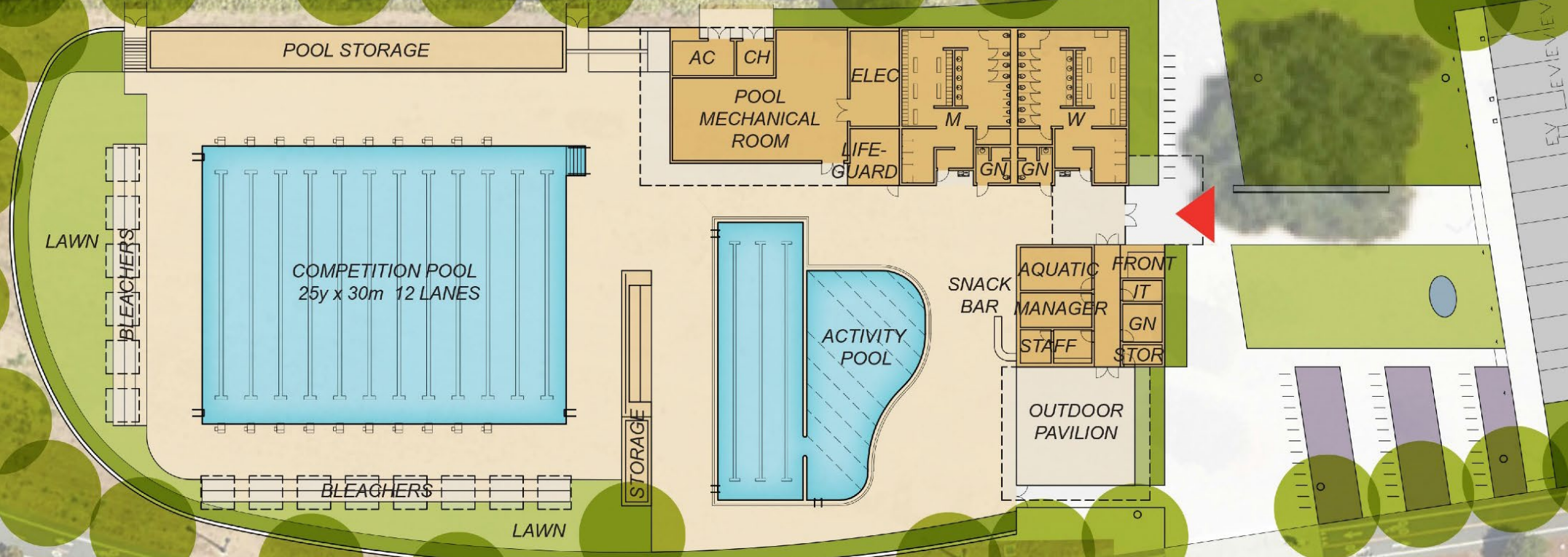





A









B

50-METER POOL



\$32.2MM

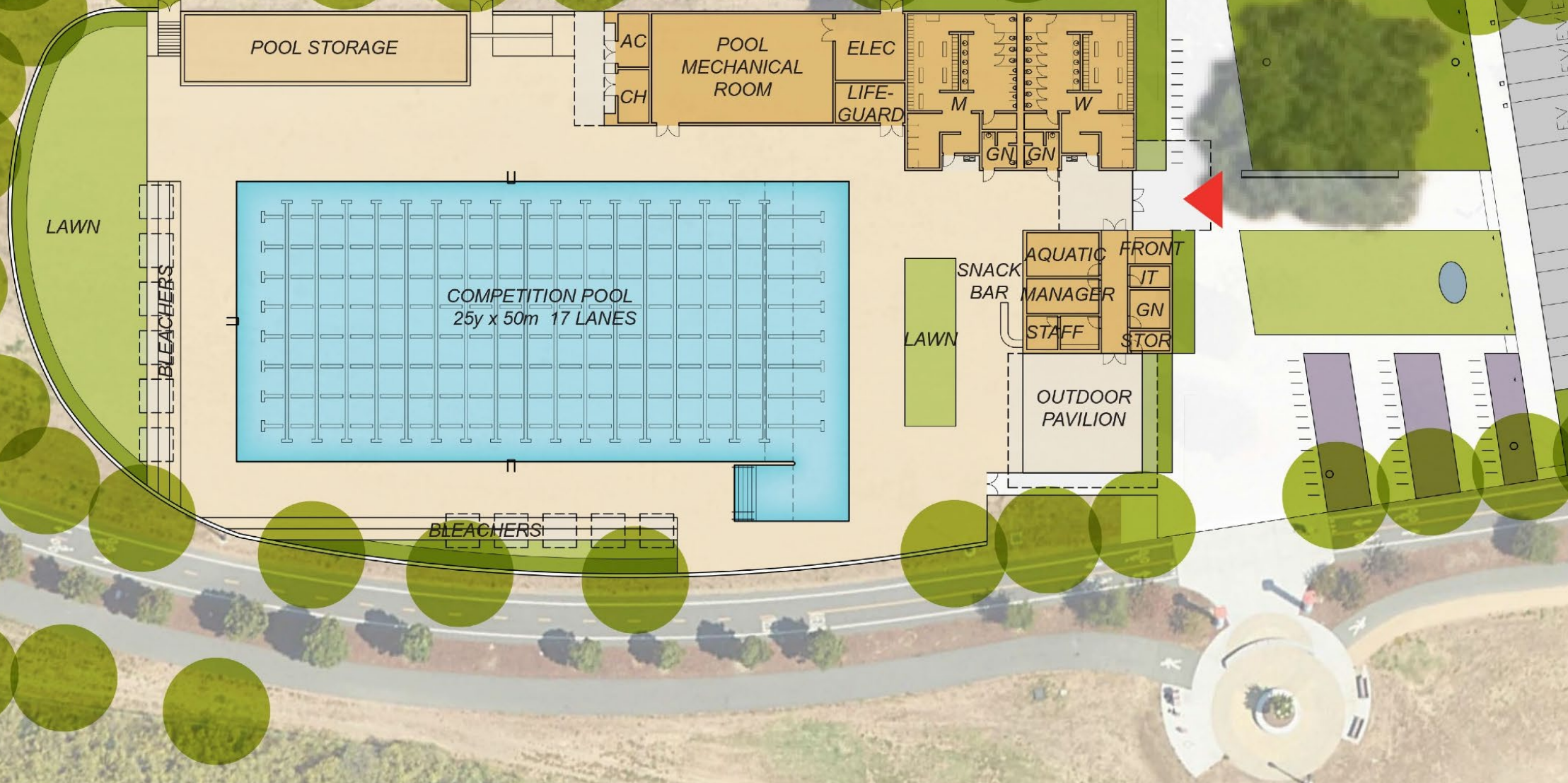







LIFEGUARD



SNACKS



ALAMEDA
AQUATIC
CENTER

AAC



ALAMEDA
AQUATIC
CENTER

AAC



Alameda

Climate Action and Resiliency Plan

CARP



LIVING
BUILDING
CHALLENGE





City of Santa Ana



City of South San Francisco

ALL ELECTRIC – ZERO GREENHOUSE GAS EMISSIONS



City of Mountain View



City of Piedmont

els/



20' - 6"

City of Piedmont – Single story building with all-electric mechanical equipment atop roof





City of Piedmont – Single story building with all-electric mechanical equipment atop roof

Concept A

Concept B
Similar

SECTION A

TOP OF PARAPET
ELEV 22'-0"

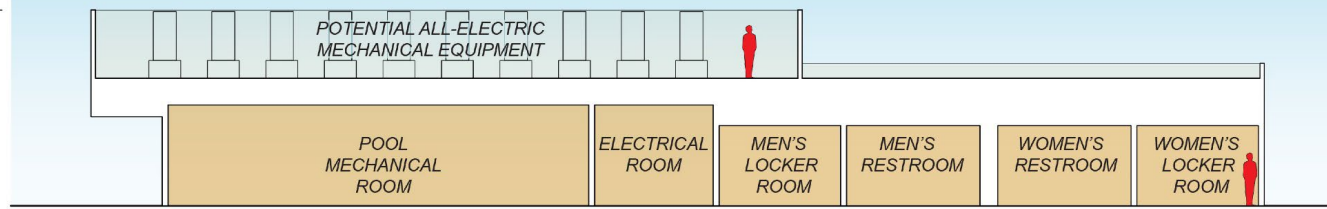

TOP OF PARAPET
ELEV 16'-0"

SECTION B

TOP OF PARAPET
ELEV 16'-0"

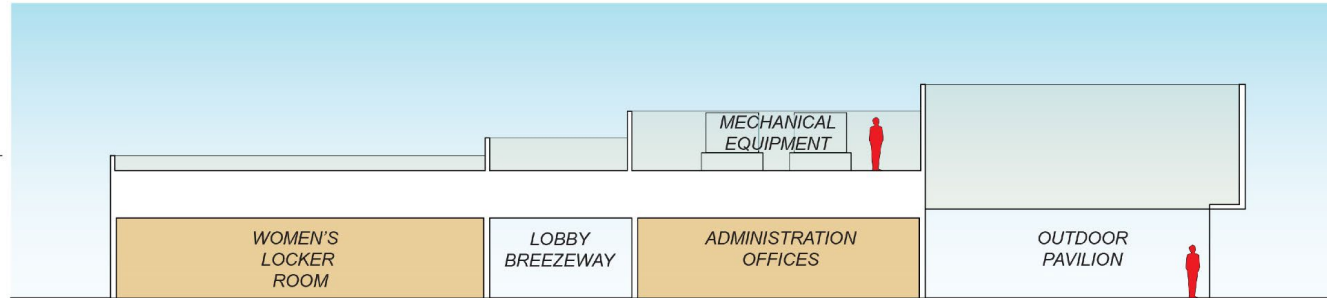

TOP OF PARAPET
ELEV 24'-0"



Alameda All Electric Scenario: Single story building with all-electric mechanical equipment atop roof

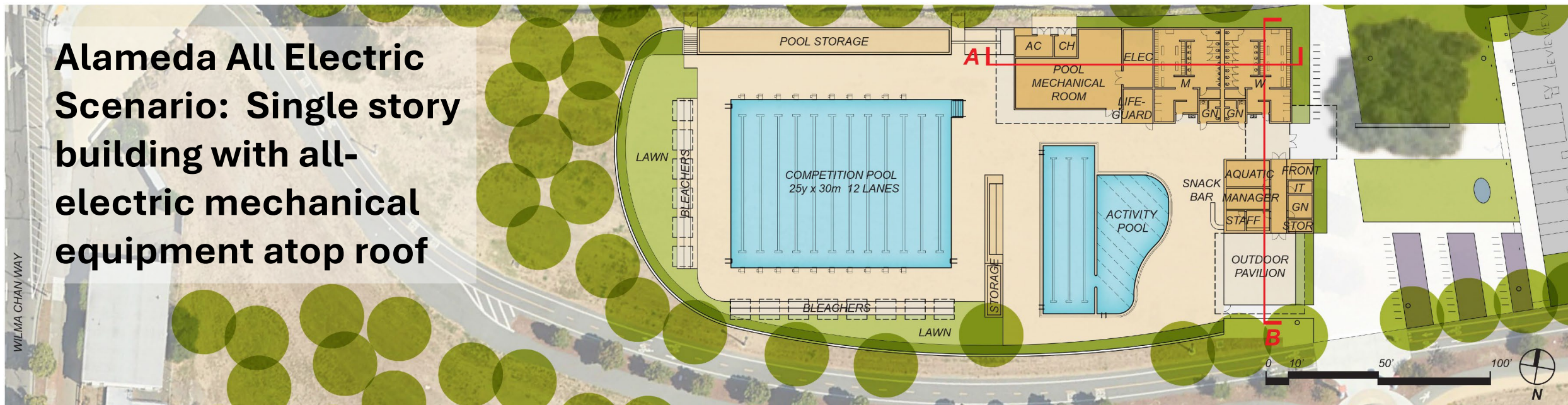

A

B

Project Budget

\$31.5MM

\$32.2MM

Electrification Cost

(\$ 1.5MM)

(\$ 1.5MM)

Revised Budget

\$33.0MM

\$33.7MM

ELECTRIFICATION

COST RECOVERY OUTLOOK

CONCEPTS A & B

A

B

Revenue	\$ 2,710,664	\$1,689,006
Expenses	(\$ 2,258,700)	(\$1,558,248)
Net Surplus	\$ 451,942	\$ 130,758
Bond Debt Service	(\$ 895,000)	(\$ 895,000)
Facilities Replacement and Repairs Fund	(\$ 500,000)	(\$ 500,000)
Ongoing General Fund Impact	(\$ 943,058)	(\$1,264,242)

EXPENSE & REVENUE PROJECTIONS



Schedule

- *City Council – Final Concept + Estimate*
- *City Council – Design Update at 100% Schematic Design*
- *Complete Design*
- *Start Construction*
- *Grand Opening*

*Tuesday, September 17
December 2024
Fall 2025
Fall 2025
Summer 2027*





Staff Recommendation Concept A - 2 pools

**Staff requests direction on the inclusion of the following
(ranked in order of community preference)**

- | | |
|---|---------|
| 1. Added Cost for Diving Well and Springboards | \$100K |
| 2. Added Cost for Multipurpose Room in lieu of Outdoor Pavilion | \$500K |
| 3. Added Cost for 100% Electrification | \$1.5MM |
| 4. Added Cost for Lobby in lieu of Open-Air Breezeway | \$200K |
| 5. Added Cost for Storage Building in Lieu of Fenced Area | \$200K |



Alameda Aquatics Center

City of Alameda



Thank You!

