

SITE PLAN DATA	
OVERALL SITE	BUILDING 91 93,000 / 2.14 AC
BUILDING EXISTING	+/- 40,800 SF
BUILDING NEW	+/- 9,000 SF
BUILDING TOTAL	+/- 49,800 SF
ZONING	ALAMEDA POINT ZONING SUB-DISTRICT VII ADAPTIVE REUSE (AR)

SITE PARKING	
PROPOSED	BUILDING 91 59 TOTAL 32 STANDARD 27 COMPACT 3 ACCESSIBLE 6 DESIGNATED  ACCESSIBLE PARKING SPACE LOCATION TO BE REVISED PER TENANT MAIN ENTRY LOCATION (*0.65/1000) X 46,200 = 30.03 (*0.6/1000) X 6,000 = 41.40  TOTAL MAX = 71.43  *PER CITY OF ALAMEDA ORDINANCE NO. 3088, XI TABLE B, PARKING RESERVE  STANDARD SPACE 9'-0" X 18'-0" **8'-6" X 18'-0" COMPACT SPACE 7'-6" X 15'-0" **11'-6" OVERHANG DRIVE AISLE 20'-0" MIN, 26'-0" MIN WHERE SPECIFIED 90 DEGREE PARKING, STANDARD 24'-0" MIN, COMPACT 23'-0"  ** PER CITY OF ALAMEDA CODE OF ORDINANCES 30.7.9 PARKING DIMENSION AND ACCESS, ADJUSTMENT TO PARKING SPACE DIMENSIONS
REQUIRED MAX.	
TYPICAL PARKING DIMENSION	

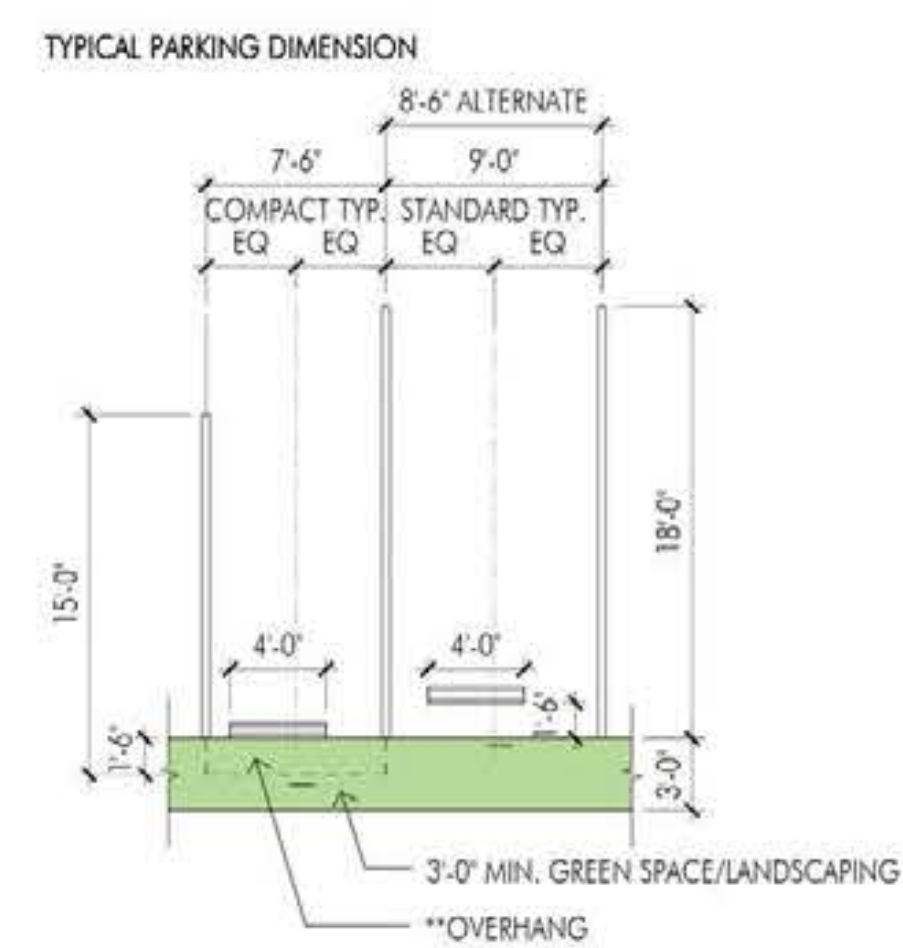

BIKE PARKING	
REQUIRED/PROPOSED	BUILDING 91 7 LONG TERM (1/18000 SF) 4 SHORT TERM (2/ENTRY)  *LONG TERM BIKE PARKING TO BE LOCATED INSIDE THE BUILDING. EXACT LOCATION TBD, TO BE COORDINATED WITH INTERIOR BUILDOUTS.  ** PER CITY OF ALAMEDA BICYCLE FACILITY DESIGN STANDARDS

GRAPHIC LEGEND	
TR	TRASH ENCLOSURE
T	TRANSFORMER
P	DESIGNATED PARKING FOR LOW-EMITTING, FUEL EFFICIENT AND CARPOOL/VANPOOL VEHICLES
EVAE	EMERGENCY VEHICLE ACCESS EASEMENT
BI	ACCESSIBLE PARKING STALLS
TR	TRASH ENCLOSURE
ABBREVIATIONS	
(E)	EXISTING
(R)	REPLACE (E) SLIDING DOOR
(N)	NEW
---	PROPERTY LINE
+	BIKE PARKING SHORT TERM - EXTERIOR
---	FIRE ACCESS ROUTE 20'-0" MIN. WIDTH W/28'-0" MIN TURNING RADIUS 26'-0" MIN. WIDTH WHERE SPECIFIED
---	DESIGNATED LANDSCAPE/GREEN ZONE
---	6' X 42" EVENT PICKET STYLE INTERLOCKING FENCE

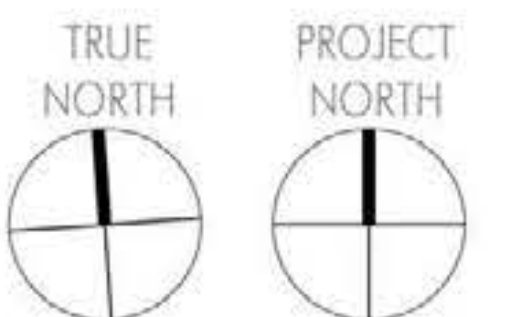
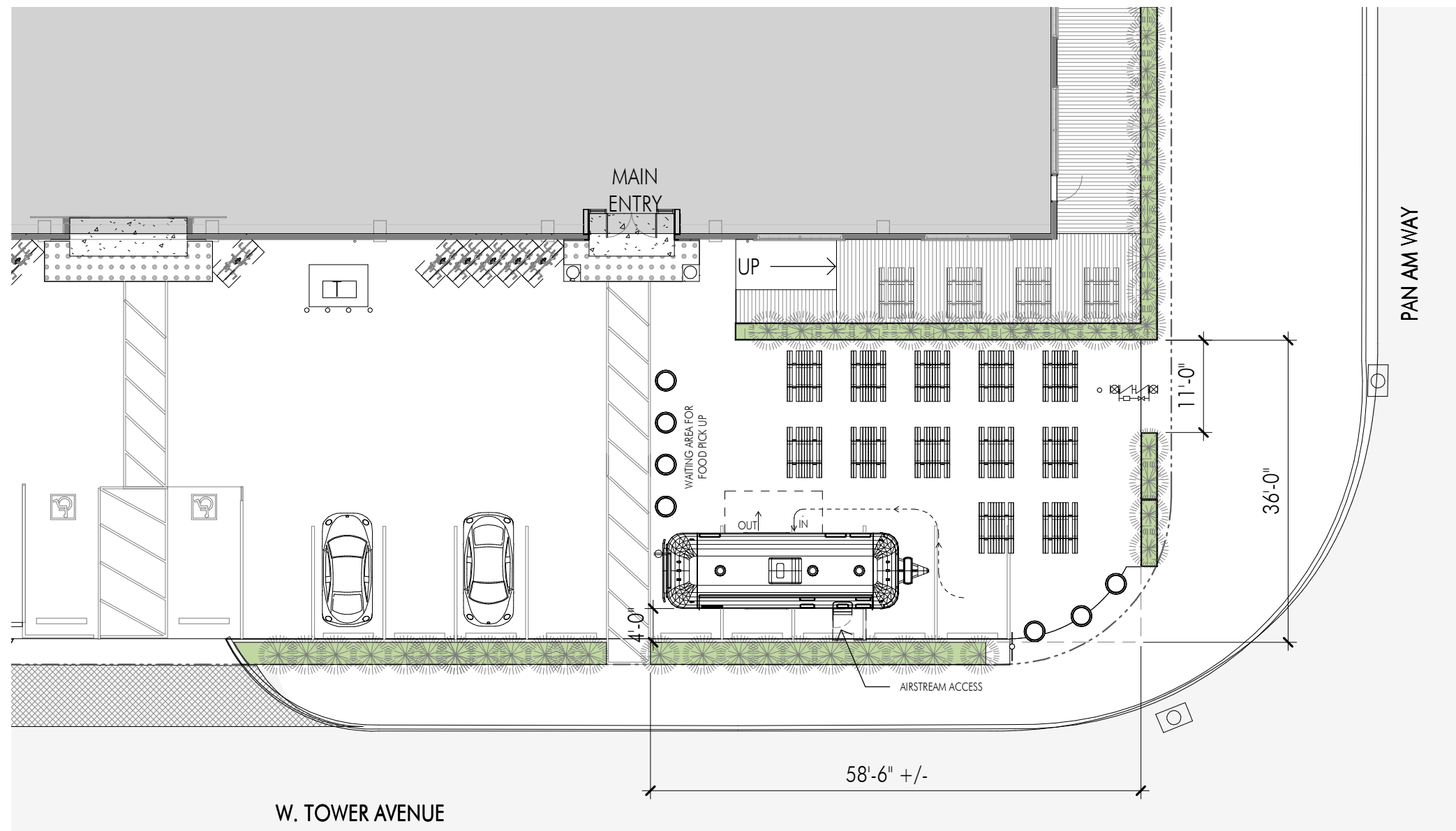

Exhibit 1  
Item 3-B, 7-16-18  
Zoning Administrator Hearing





## SITE - ENLARGED PLAN - AIRSTREAM OPTION 02

1/16" = 1'-0"

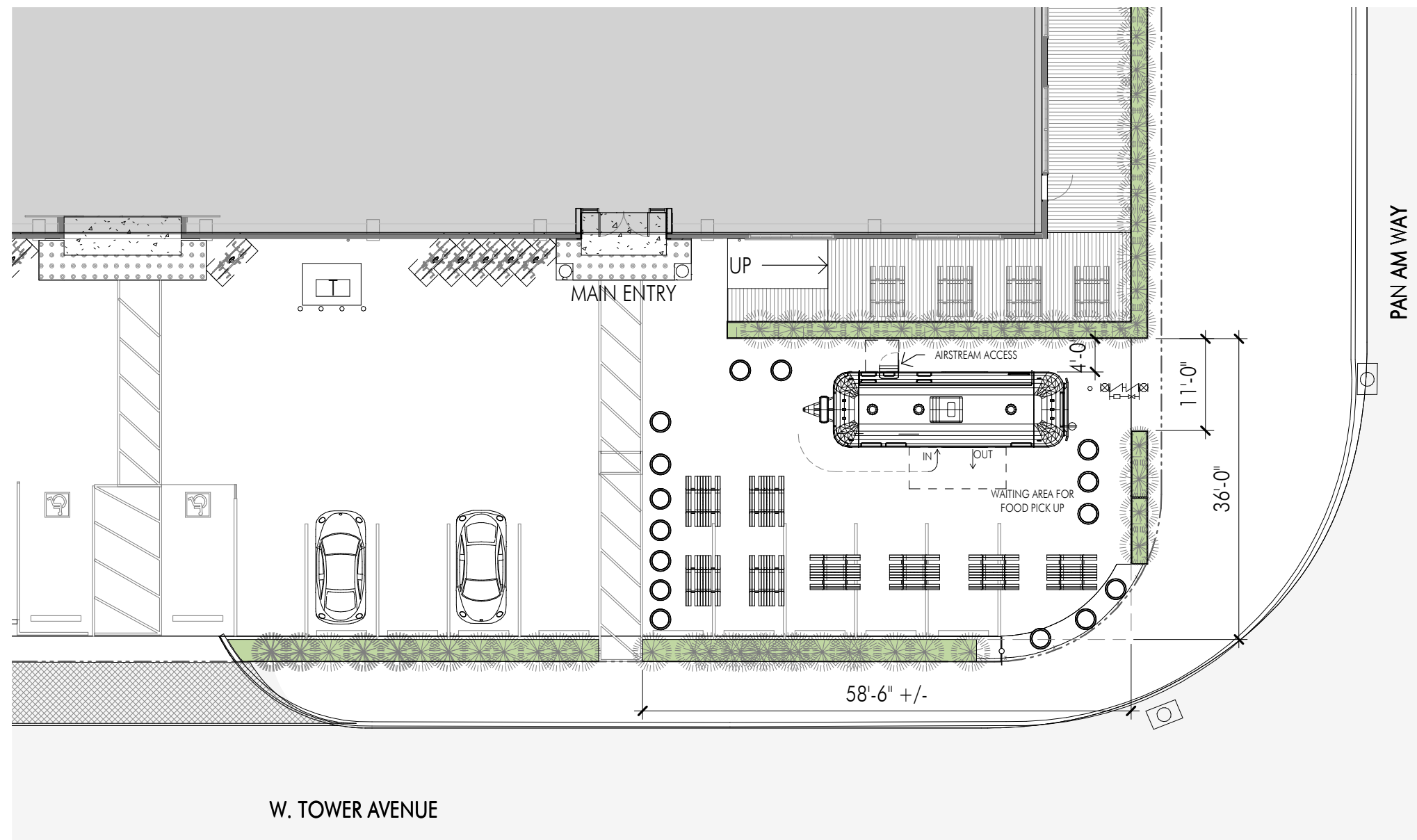

# LEGEND

- EXISTING FIRE RISER
- ELECTRICAL ACCESS
- INDICATES CLEAR AREA
- PROPERTY LINE
- FENCING OR BARRIER
- SIGNAGE
- WATER HOOK UP
- TRANSFORMER

## SITE - ENLARGED PLAN - AIRSTREAM OPTION 03

1/16" = 1'-0"