

# CITY OF ALAMEDA DOMESTIC VIOLENCE REPORTS 2017

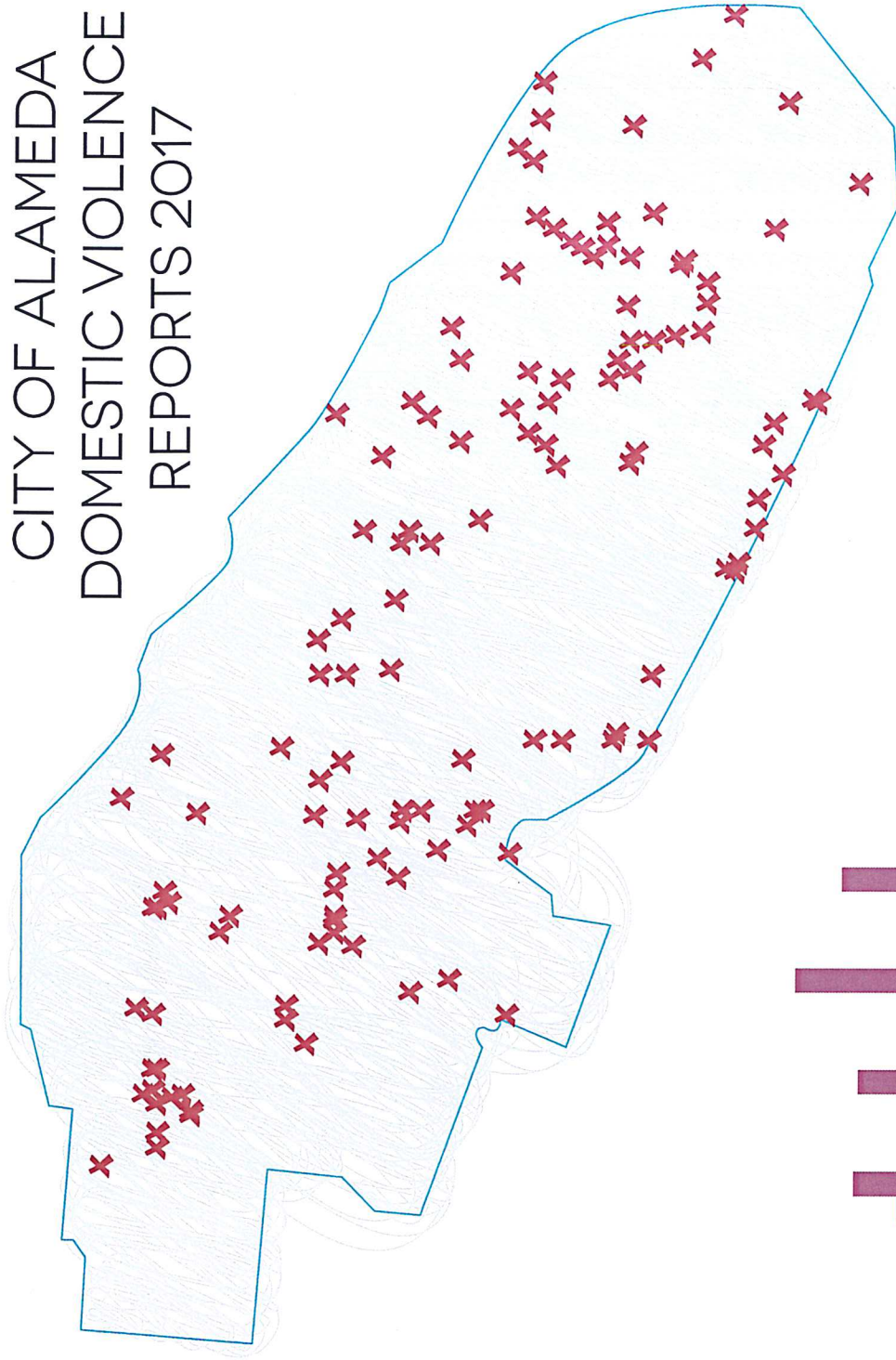

BAY FARM ISLAND

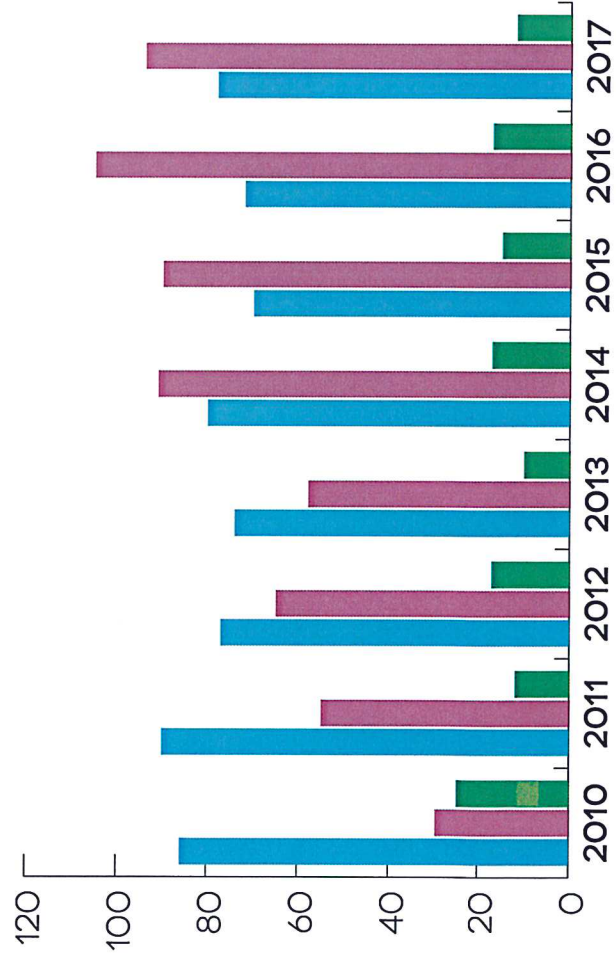
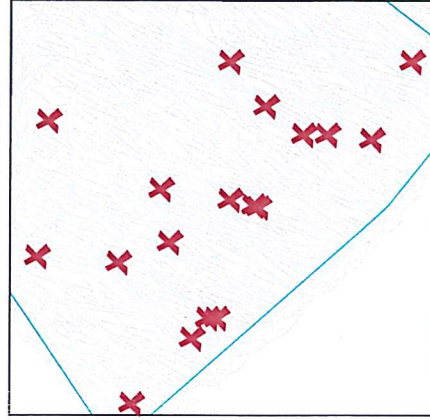

Domestic Violence

Domestic Violence, visible injury

Domestic Violence related other crimes

Submitted by Jessica Rogers  
Re: 2-6  
10/2/19



# Saturday Social at Cleophus Quealy

**SATURDAY, OCTOBER 13TH FROM 12-6PM**

**Cleophus Quealy Beer Co.**

**448 Hester Street, San Leandro, CA 94577**

Saturday Socials are our way of giving back to the community that so enthusiastically supports us. On the second Saturday of every month, we join forces with a local non-profit organization to raise both funds and awareness for their efforts to make the Bay Area a better place. We invite our friends, neighbors, and beer lovers from all around to join us in having a great time for a great cause.

On Saturday, October 13th from 12-6pm we're partnering with Building Futures. For 30 years, Building Futures has provided resources, programs, and services to help residents in San Leandro and throughout Alameda County build futures free from homelessness and family violence.

October is Domestic Violence Awareness month, and we'll spend the month highlighting and supporting Building Futures' domestic violence services. During our Saturday Social on the 13th, you're invited to add to the What is Love? Healthy Relationships collage wall, and snap a selfie in the Love is Respect photo booth.

We're also releasing a super special barrel-aged beer brewed by the women of Cleophus Quealy.

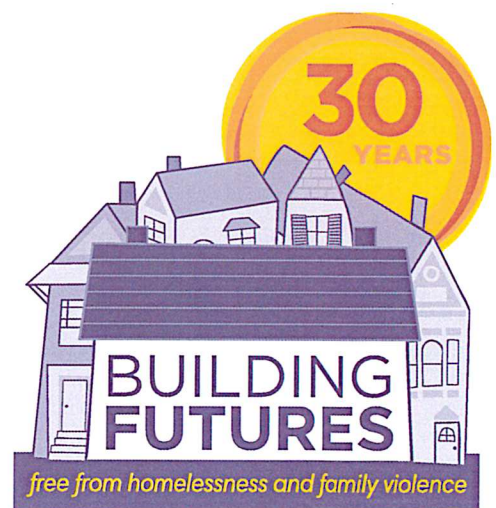

## HOW IT WORKS

We do things a little different during Saturday Socials.

- For \$20, you'll receive a Cleophus Quealy mason jar plus two tokens for full beers at the bar, and make a donation to our non-profit partner.
- Tokens for additional beers can be purchased at \$5 each. (Menagerie discount will apply!)
- Children, dogs, and well-behaved adults are all welcome!

**Visit our website: [Cleoph.us](http://Cleoph.us)**

ALAMEDA  
HOMELESS  
NETWORK



# 2017-2018 MIDWAY SHELTER ANNUAL REPORT

MIDWAY SHELTER, PO BOX 951, ALAMEDA, CA 94501 • FEDERAL TAX ID: 94-3078153

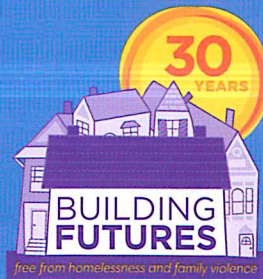

## Alameda's Midway Shelter

**D**id you know that Midway Shelter has served as a place of refuge and healing for almost 30 years? Thousands of futures have been changed for the better in this special place. Alameda's community has stepped up to help by donating funds, shelter supplies, items for women and children, nutritious meals, and more.

In 1989, a handful of community members from the city's Homeless Task Force responded to then-mayor Chuck Corica's concerns about unsheltered people in Alameda. The small group said yes to the challenge of sheltering those in need, forming the Alameda Homeless Network (AHN). That year, Midway Shelter opened its doors. The all-volunteer AHN works hard all year to secure funding to keep Midway Shelter operating 24 hours a day, while raising community awareness of the shelter's needs and successes. In partnership with AHN, Building Futures provides an array of support services at Midway. Residents receive case management, life skills groups, domestic violence and housing services, community resources, and children's programming. All are designed to help women and children build safe, secure futures. Building Futures also provides Midway residents with all the benefits of their wide-ranging domestic violence and housing services.

We are proud of the progress Midway residents made last year with the help of the Alameda community. Please accept our gratitude for your support of Midway. You are making fresh starts possible for women and children in need!

AHN is always seeking new members. If you'd like to help and have about five hours a month to help keep Midway strong, please contact AHN President Kari Thompson at [karithompson63@gmail.com](mailto:karithompson63@gmail.com).

## 2017-18 NUMBERS SERVED

<b>81</b>	<b>46</b>	<b>46</b>	<b>35</b>
individuals	households	women	children

### HOUSING OUTCOMES

**41%**  
exited to housing

### AVERAGE LENGTH OF STAY

**61-90 DAYS**  
(2 to 3 months)



## Races Fund Midway

**Y**ou may have heard about the Fourth of July 5K that precedes Alameda's famed parade. Or the even older Midway 5K Run/Walk on Bay Farm Island. The latter was launched in the early 90's by Bob DeCelle and the Alameda Homeless Network, then known as the Mayor's Committee for the Midway Shelter for Women and Children.

"We lived in Alameda and did 'fun runs' around the Bay Area," says Mark Hovermale, who today operates both charity 5Ks with his wife, Cindy. "We read about the Midway Run in the local paper. We normally traveled to San Francisco or Marin County for runs. The Midway Run sounded great, since it was so close to home. Back then, the event drew about 50 runners. Cindy (pictured second from left) came in second when she was three months pregnant with our son, Andrew, now 22."



*Run/walk organizers and AHN board members Cindy and Mark Hovermale with daughter, Christine, and son, Andrew.*

When DeCelle passed away, Mark called Tony DeSimone, the Chairman of Alameda Homeless Network. "I asked who'd be putting on the race," Mark remembers. Tony said, "Why don't you and Cindy do it?" The Hovermales rose to the challenge, and the two have organizing the Midway Shelter Run ever since. Each year, the run takes place on the first Saturday in December.

Before the 2000 Fourth of July Parade, the Hovermales noticed the streets were cleared of traffic at least an hour before the parade began. It seemed to Mark and Cindy that conditions were ideal to hold a second 5K before the parade and raise more money for Midway.

**"The first year drew about 65 runners. In 2011, we broke the 500 participants mark, and in 2018 we had 1,018!" Mark says.**

Today, Fourth of July runners might arrive with tutus, costumes, and baby strollers. It's a timed race, drawing serious runners like the state championship cross country team from St Joseph's of Notre Dame. Over five years, The Midway Race and Fourth of July R.A.C.E have raised over \$100,000 to support Midway's services for women and children. Boy Scouts Troop 2, Ed Jay Photography, and Building Futures have provided volunteer services. "On the day of every race, I'm struck by the feeling of unity. I love the way the 5Ks bring the community together for a good cause," Cindy says.

## THE MIDWAY SHELTER 5K RACE AND 1 MILE WALK

**SATURDAY, DECEMBER 1, 2018 • 9:00 AM**

*Starts at the Harbor Bay Ferry Terminal on Bay Farm, Alameda at the end of Mecartney Drive.*



For sponsorship information, please contact Mark Hovermale at [MarkHovermale@Comcast.net](mailto:MarkHovermale@Comcast.net).

Sponsorship benefits include acknowledgement on event t-shirts and materials, as well as runner/walker entries. Benefit packages extend across THREE ANNUAL EVENTS benefitting the Midway Shelter: the Midway Race, our annual Gala, and The 4th of July Mayor's R.A.C.E.!

### REGISTRATION

\$15 for 18 and under;  
\$20 for 19 and older.

Free 1/2 mile children's fun run for children 11 and younger.

All proceeds of this event benefit the Midway Shelter.

For registration and run/walk details, visit [AlamedaRace.org/Midway/](http://AlamedaRace.org/Midway/)

**1 in 3 women  
will experience  
domestic violence  
in her lifetime.**

**#dvam18**

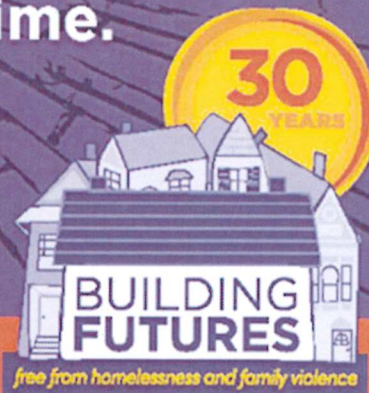

**Building Futures provides  
Alameda County with safe,  
confidential shelter, 1:1 support,  
community support groups,  
housing assistance, and more.**

**Call 24/7: 1-866-A WAY OUT**