

© MG2. All rights reserved. No part of this document may be reproduced in any form or by any means without permission in writing from MG2.

3333 Michelson Dr
Ste 100
Irvine, CA 92612
949 705 0700
MG2.com

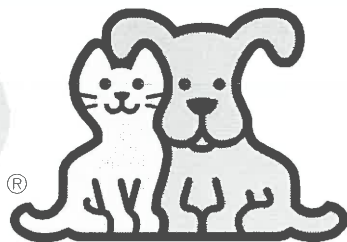

OCT 01 2014

Petco Alameda, CA

2310 South Shores Ctr.

Existing Plan

19-5114-01A
PM: M. McClellan
05/28/19

A-02

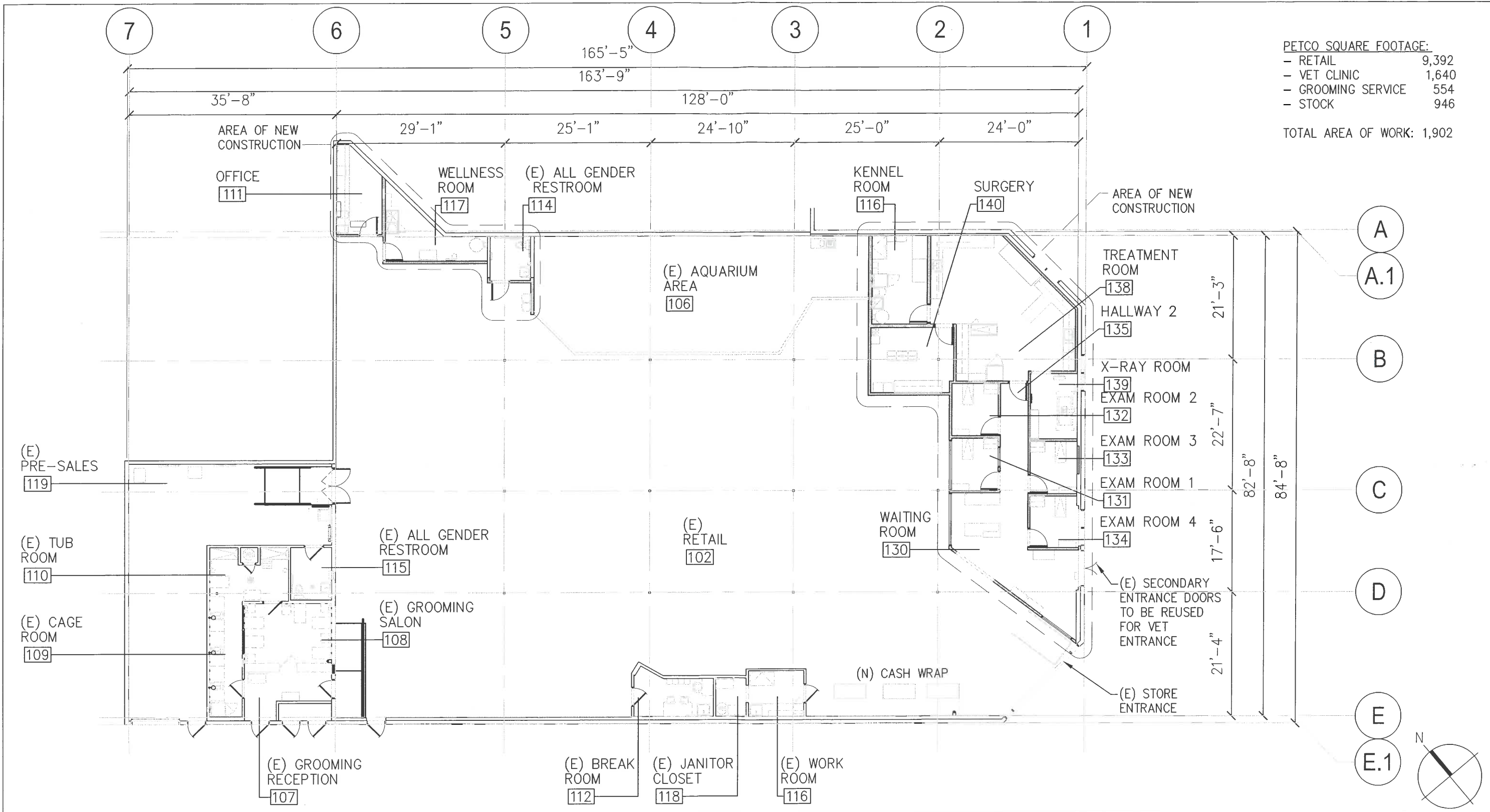

© MG2. All rights reserved. No part of this document may be reproduced in any form or by any means without permission in writing from MG2.

3333 Michelson Dr
Ste 100
Irvine, CA 92612
949 705 0700
MG2.com

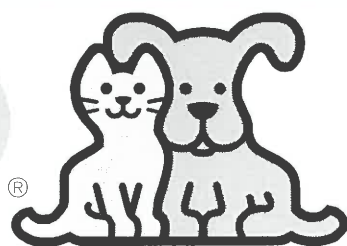

OCT 01 2019

Petco Alameda, CA
2310 South Shores Ctr.
Proposed Interior Remodel Plan
For Adding Veterinary Services

19-5114-01A
PM: M. McClellan
05/28/19

A-03