

CHOCHENYO PARK

SIGNAGE
LANDING
IDEA
INSPIRED BY
MEDICINE
WHEEL

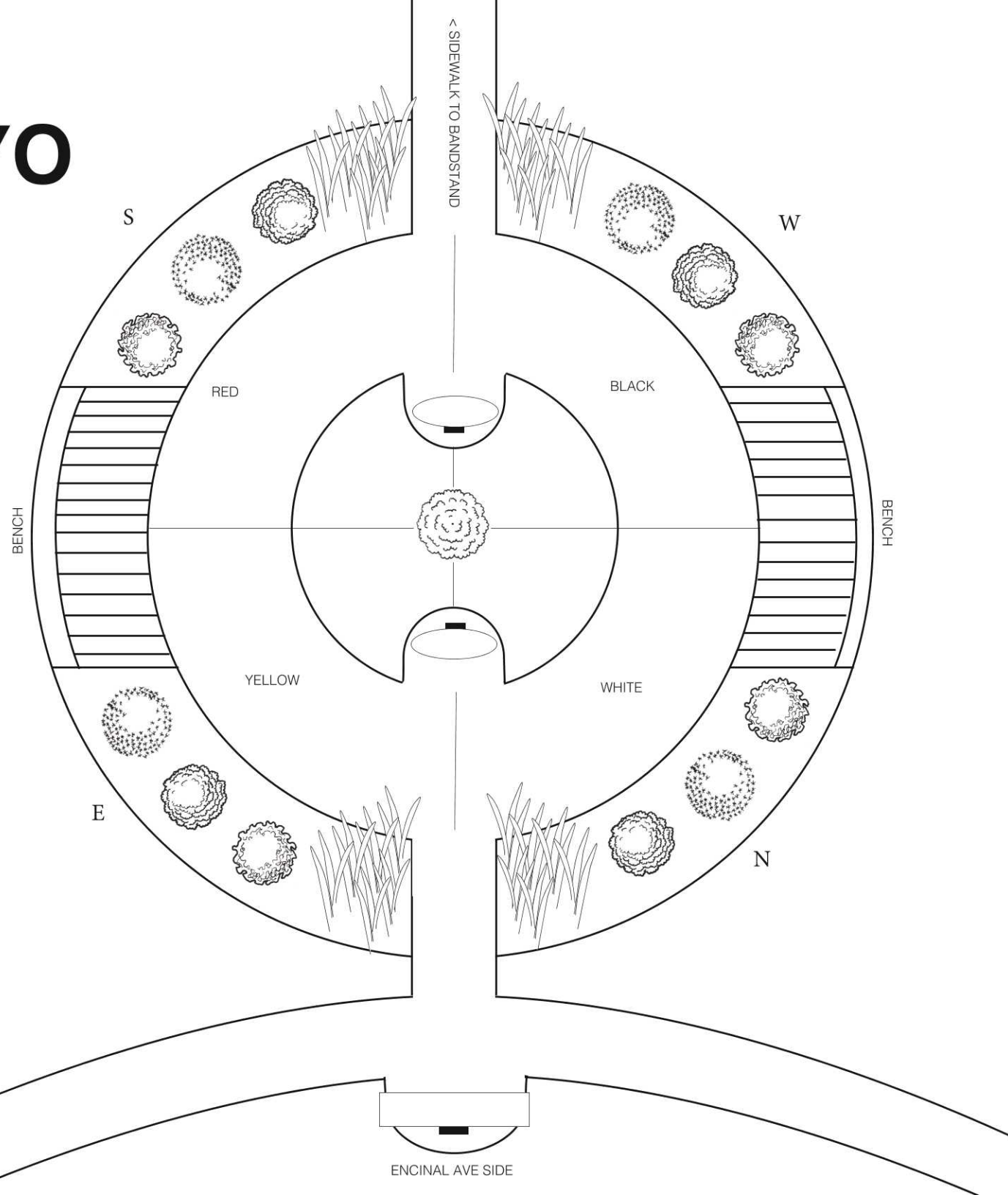



WITH THE UNPRECEDENTED PARTNERSHIP OF THE OHLONE TRIBE AND CITY OF ALAMEDA, AN IMPORTANT STEP OF HEALING BEGAN WITH THE RENAMING OF JACKSON PARK TO CHOCHENYO. TO CONTINUE THE PROCESS, SIGNAGE AND A LANDING AREA AT THE ENTRANCE OF THE PARK WILL UTILIZE THE MEDICINE WHEEL TO FURTHER THE HEALING AND GOOD WILL.

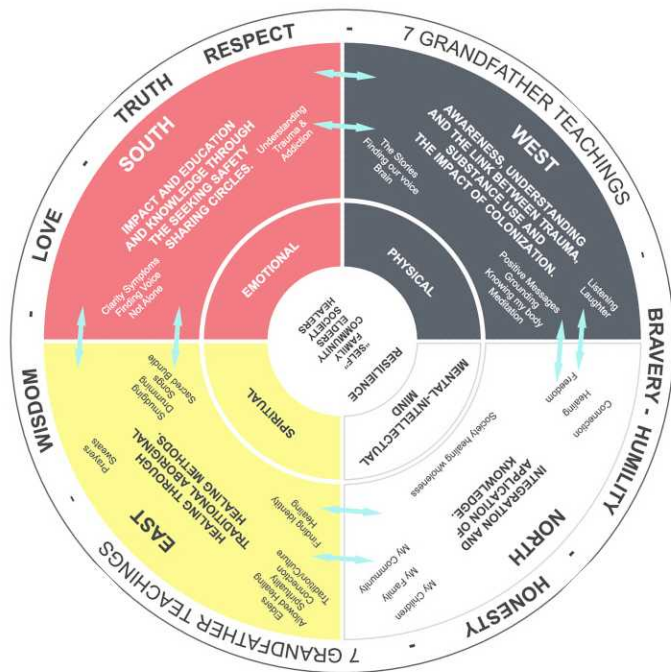

THE LANDING WOULD BE DIVIDED INTO 4 SECTIONS OF THE WHEEL. EACH SECTION IS POSITIONED IN DIRECTION IT COORESPONDS TO. AND EACH SECTION WOULD ENBODY THE COLOR ASSOCIATED

THE LANDING WOULD BEGIN FROM THE ENCINAL AVE. SIDE AND HERE THE SIDE ARCH BEGINS A STRAIGHT PATH TO THE GAZEBO

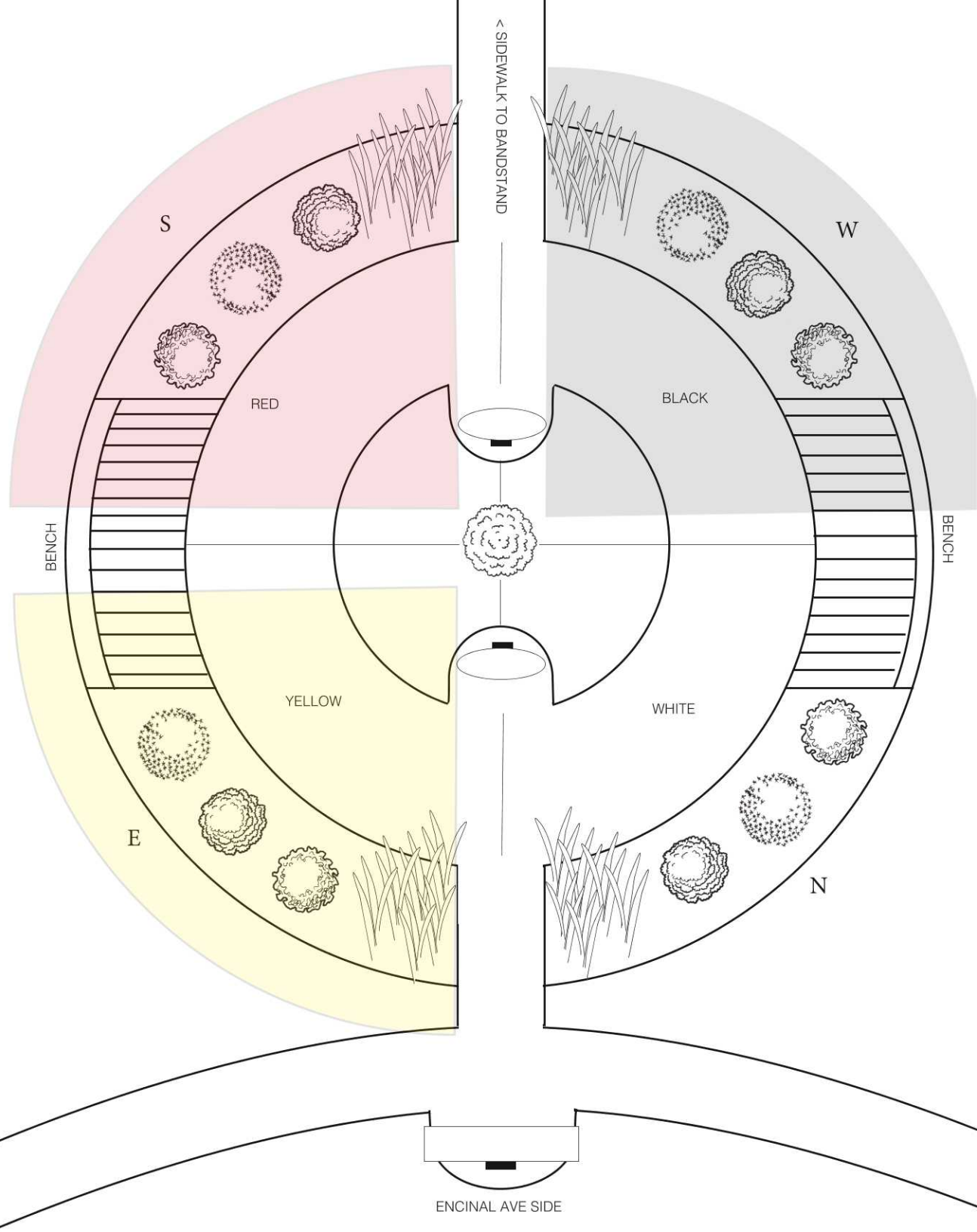

A



B

Frameless Pedestal Mount Style

For use with 1/2" thick self-supporting sign panel

1/2" thick self-supporting high pressure laminate sign panel

3/16" thick frameless mount plate

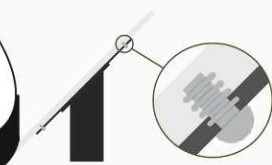

1/2" thick HPL panels are blind mounted with fasteners that pass through the underside of the mount plate into the threaded holes on the back of the sign panel. Self supporting HPL panels do not require full, edge to edge, support.

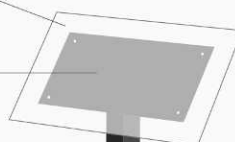

Sign pan 30-32" fr

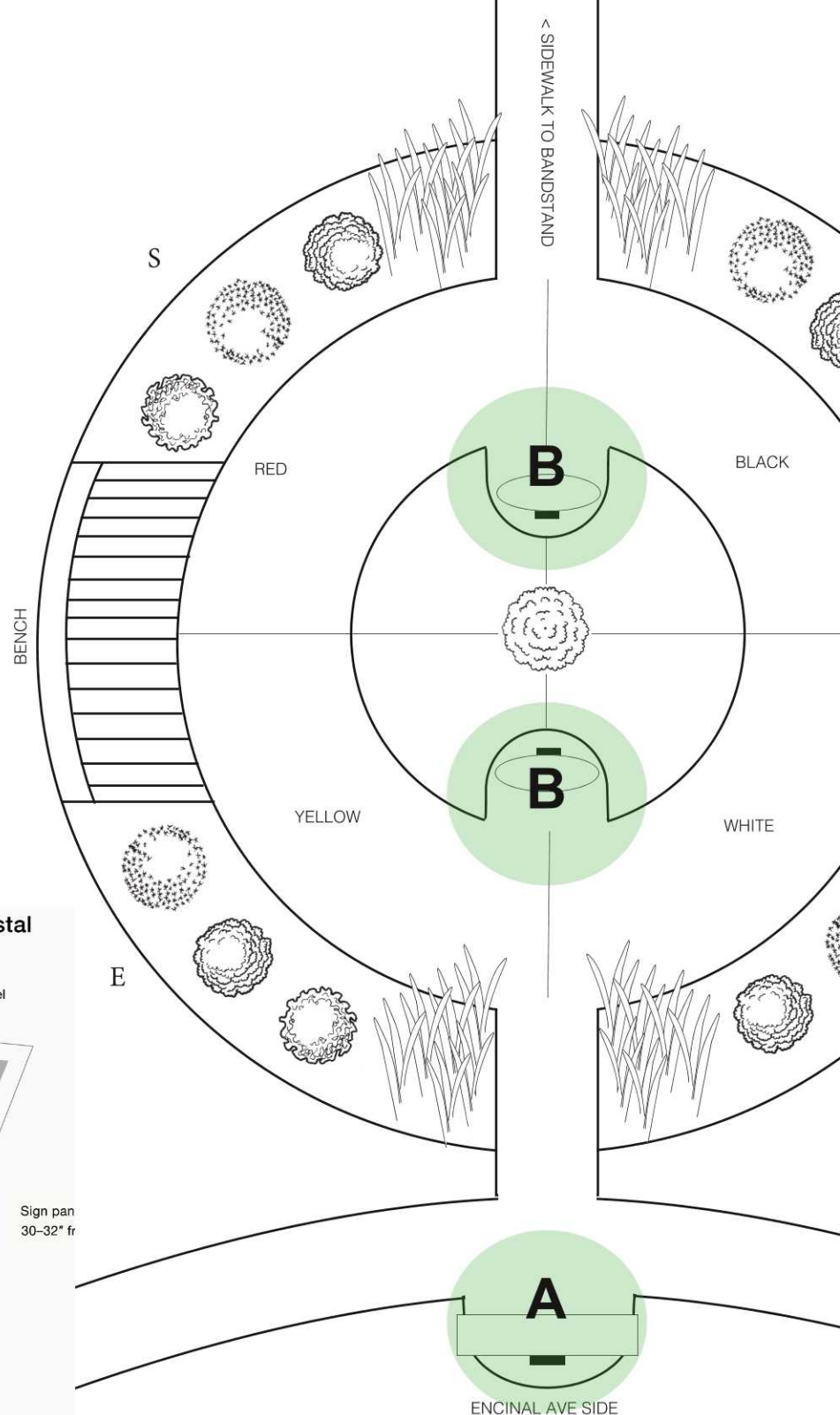

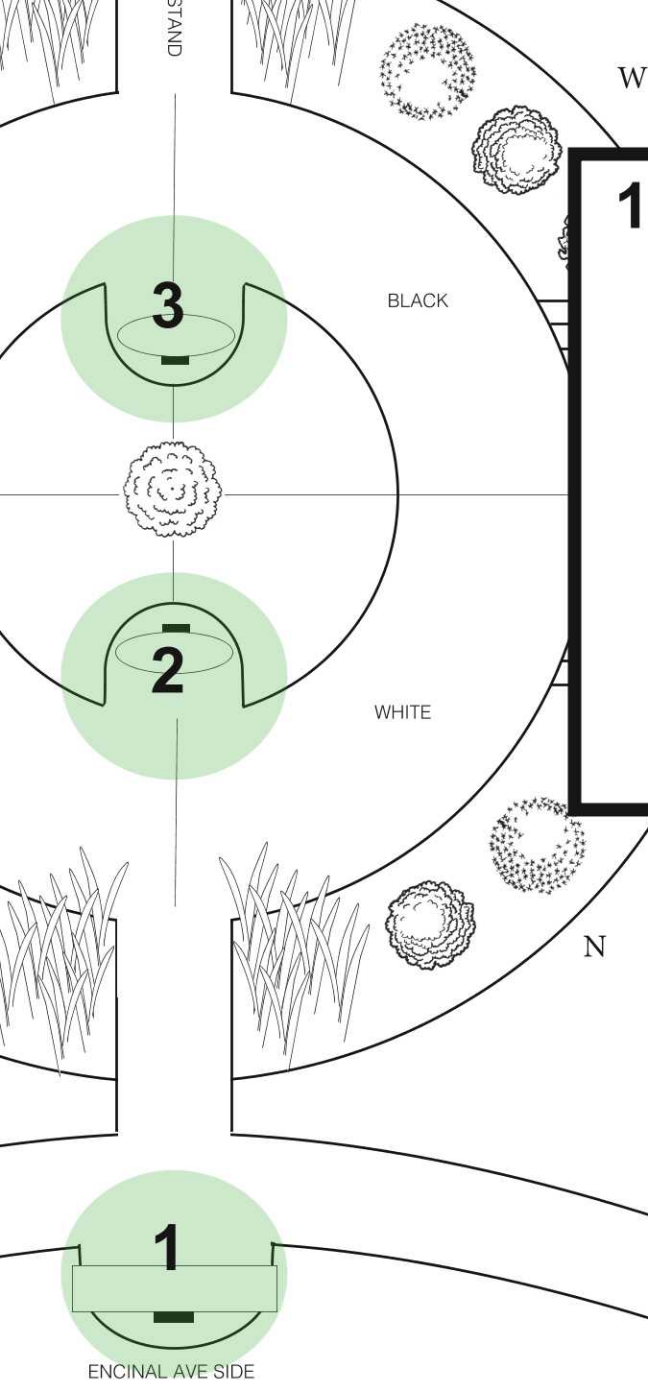

1

How did the park get its name?

IMAGE

Late 1700s
When Spanish colonizers first arrived to this place, they took violent and brutal actions to try to break the connection between the people and the land. The settlers claimed this land as their property. Many Ohlone people were displaced or forced onto missions; many were killed or died from disease or poor nutrition.

1867
Created as a private garden for the nearby houses in the Alameda Park neighborhood. It was owned by Alfred A. Cohen, an English immigrant and banker.

1895
Became Alameda's first public park, landscaped by John B. Canine. People called it Alameda Park.

1890
A handstand designed by Joseph A. Leonard was built to host summer concerts for the public.

1920
Animal welfare advocate Isabella Derby Clark donated a concrete bench to the park. It was designed by architect Myrtle Maillot.

1909
The city named 4 public parks after U.S. presidents; this one honored Andrew Jackson. Many other parks, schools, and streets in the U.S. were named after Jackson during this period.

2018
At a City council meeting, community member Rashad Shahzad proposed to change the park's name, acknowledging the truth of Jackson's legacy. Jackson was an enslaver, who helped expand plantation slavery by seizing land from Native Americans. Many Native Americans were displaced or killed in the process, known as the "Trail of Tears".

The Rename Jackson Park group formed to advocate for a more inclusive name.

Jackson Park, 1909-2020
Over the years, the civic engagement of park neighbors was responsible for preserving the green space much as it was. Jackson Park was a site for many picnics and gatherings, and sometimes also a meeting point for social justice demonstrations. In the early 2000's, it hosted an annual Art in the Park fair.

2020
The rise of change law space, inch Council de group was engaging w of the Laji chosen. It w with the tril

2

Signage on one-side of the shellmound would say who the Ohlone People are and about the Park name

3

Signage on other-side of the shellmound would explain the medicine wheel design and the plants and the Ohlone's connection to the plants.

TOBACCO



California White Sage



Indian Tobacco

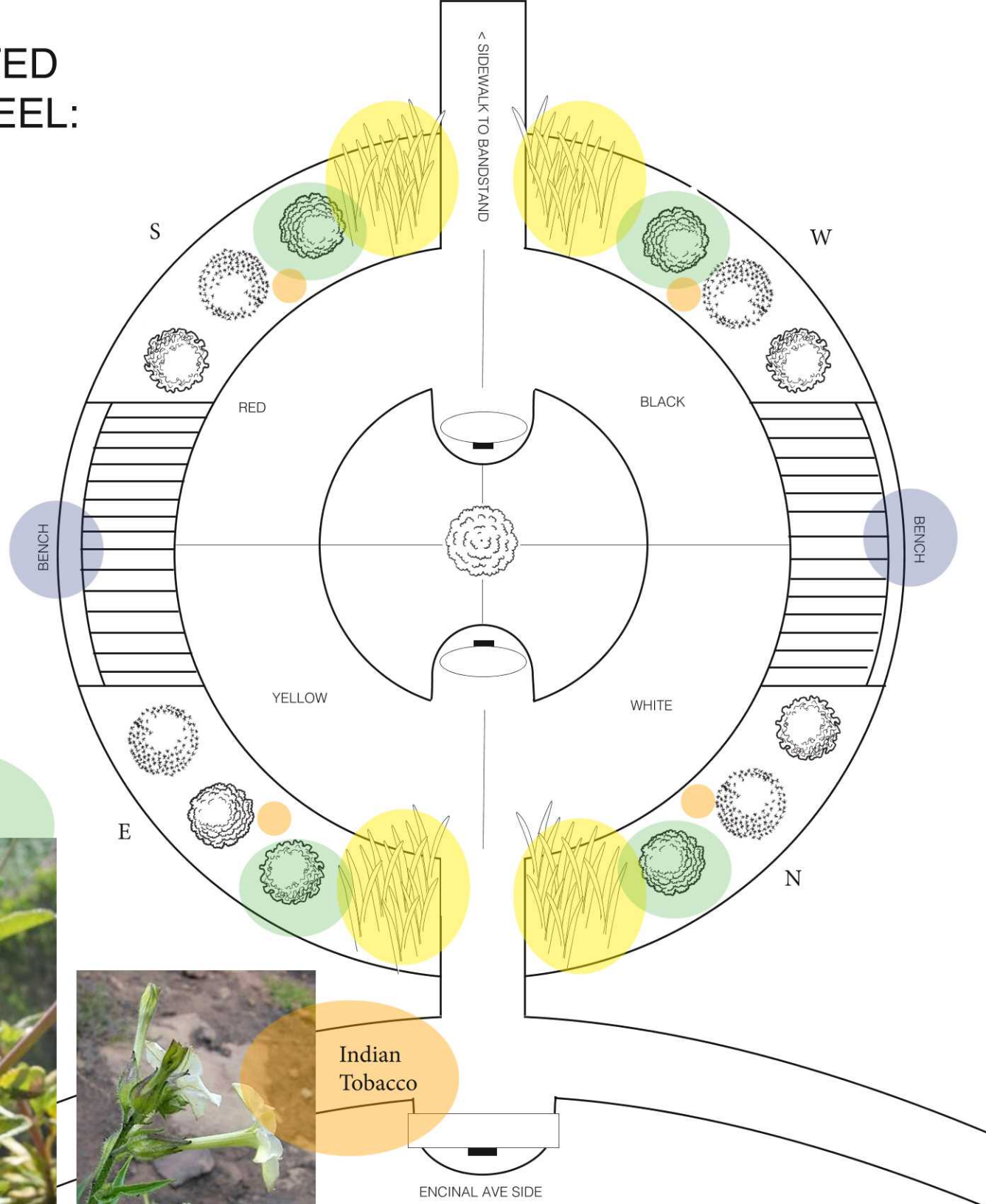

PLANTS USED BY THE OHLONE TRIBE:

THESE PLANTS COULD BE PLANTED IN THE
PLANT BEDS

- A. Yerba Santa (*Eridictyon californicum*)
- B. Black sage (*Salvia mellifera*),
- C. California Wild Rose (*Rosa californica*)
- D. Lemon Balm (*Melissa officinalis*)
- E. Rue (*Ruta chalepensis*)
- F. White Sage 7 (*Salvia apiana*)
- G. Soap root (*Chlorogalum pomeridianum*)
- H. Yerba Buena (*Satureja douglasii*)
- I. Yarrow (*Achillea millefolium*)
- J. Coffeeberry (*Rhamnus californica*)
- K. Bearberry (*Arctostaphylos uva-ursi*)
- L. Mugwort (*Artemisia douglasiana*)
- M. Rutaceae - Fringed Rue





California Red Rose

EACH SECTION OF THE WHEEL
WILL HAVE PLANTS THAT
BLOOM THE COLOR OF THE
SECTION



Bearberry

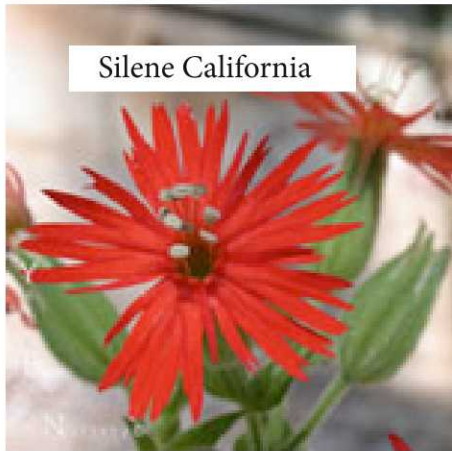

Silene California



Red Sage

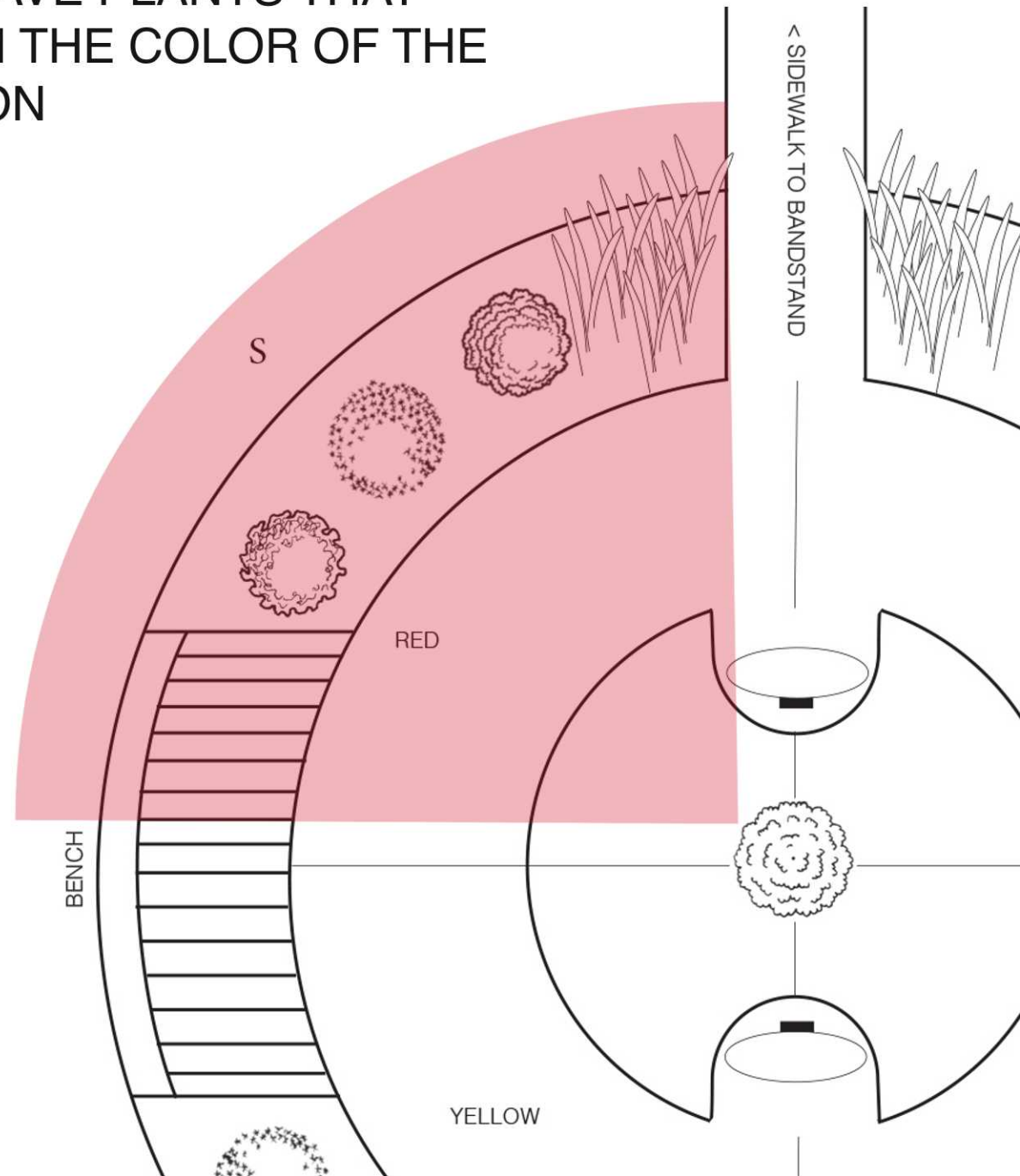

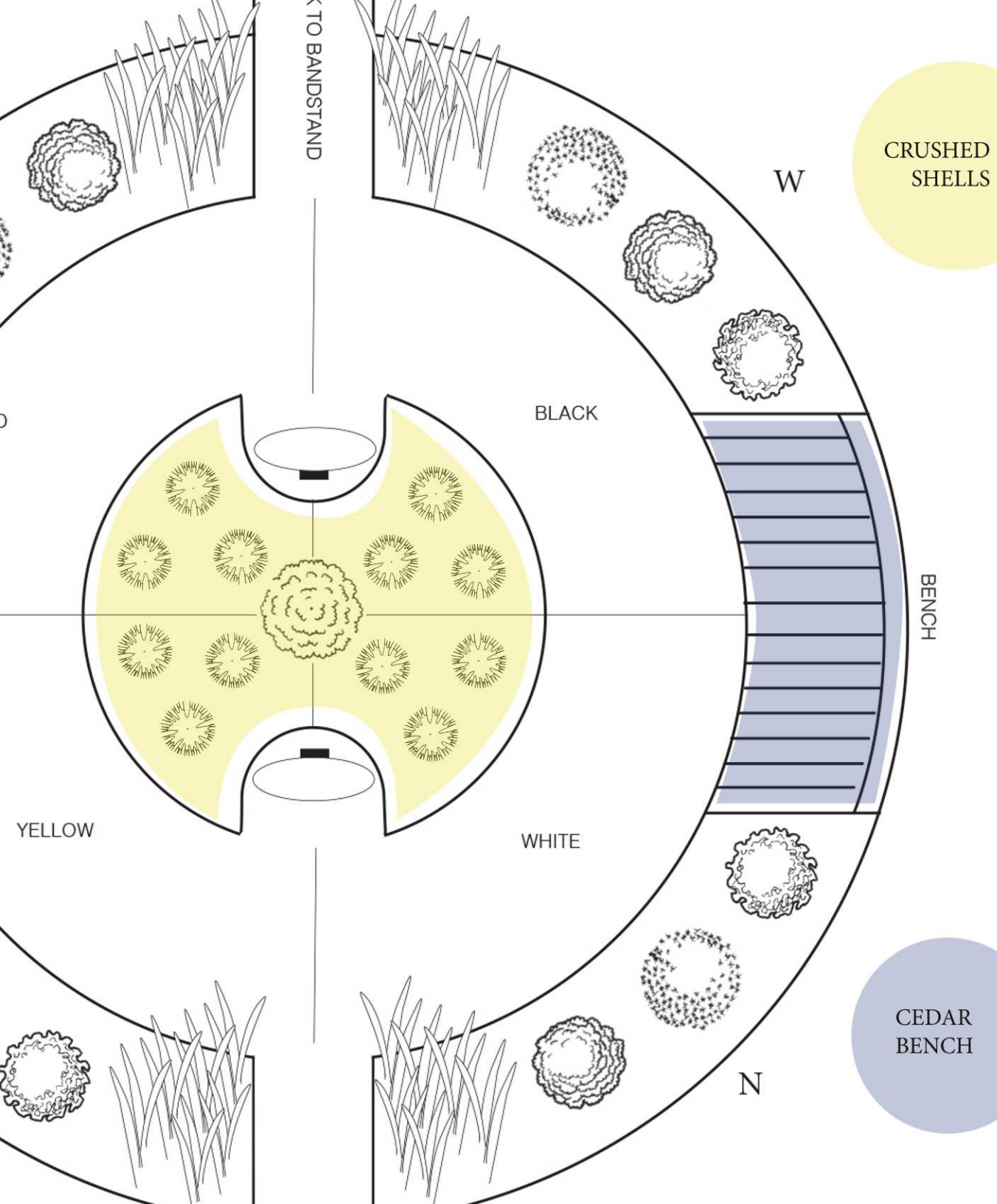

The center circle would be a mounded and covered in crushed shells. This would be to honor the shellmounds of the Ohlone People.

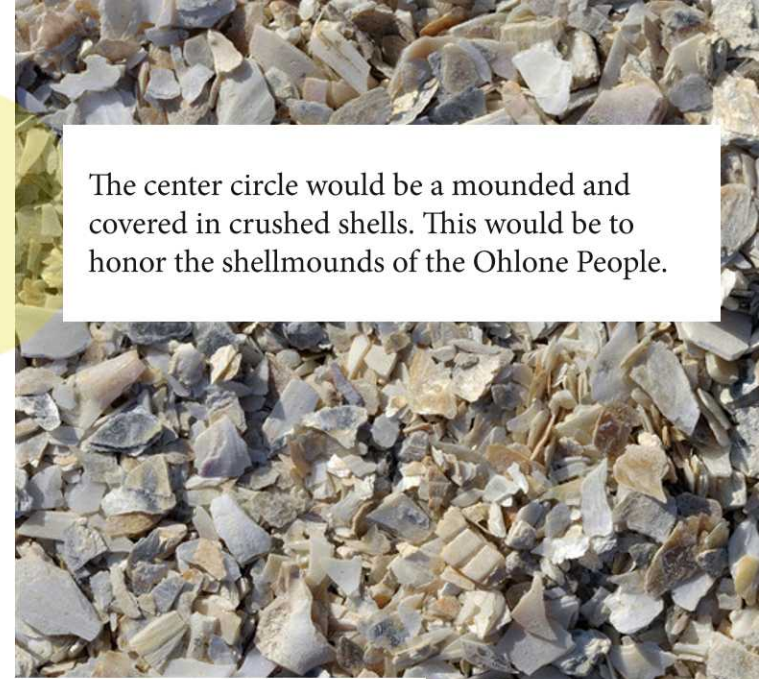



COLOR DYED
CONCRETE

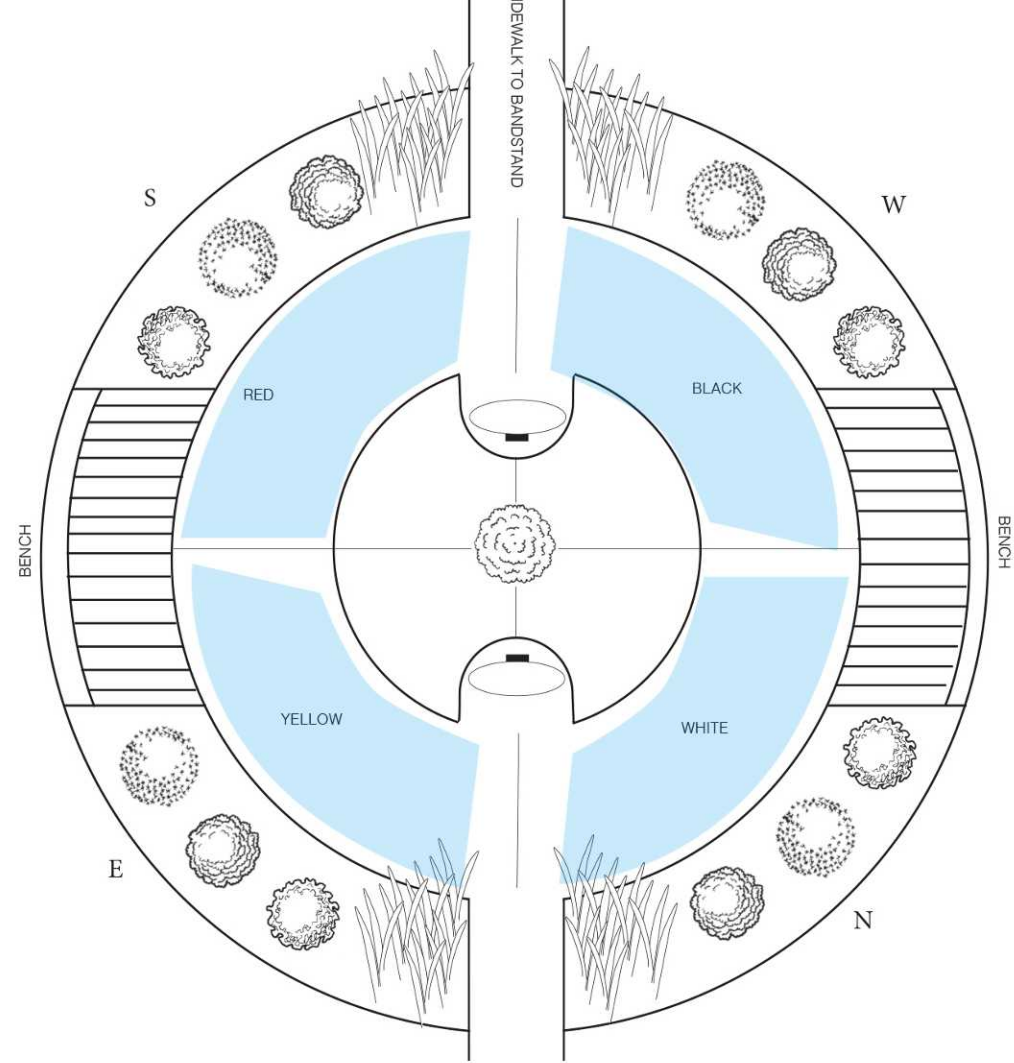

ANOTHER OPTION TO BRING THE COLOR IN
INSTEAD OF THE CONCRETE WOULD BE PUT
A SMALL COLORED STRIP OF METAL THAT IS
THAT COLOR THAT HOLDS THE LOW PLANT-
ING BEDS AND THE THE CENTER MOUND